

StrikeRisk v6.0 IEC/EN 62305-2 Protection Against Lightning Risk Management Software

The screenshot displays the StrikeRisk v6.0.0.88 software interface. The 'Protection' tab is active, showing various input fields for risk assessment. The 'General' section includes fields for Zone identification, location, soil type, fire protection, and shielding. The 'Lines' section shows risk calculations for different types of lines (L1, L2, L3, L4). The 'Zones' section shows risk calculations for different zones (Z1, Z2, Z3, Z4). The 'Financial' section shows risk calculations for different financial impacts (RA, RB, RC, RM, RU, RV, RW, RZ).

Property Name	Total	Zone 1	Zone 2	Zone 3	Zone 4	Zone 5
R1 - Risk of loss of human life						
RA R1	1.066 E-08	0.000 E00	0.000 E00	1.099 E-09	8.791 E-08	7.692 E-10
RB R1	4.778 E-05			4.395 E-05	3.516 E-06	3.077 E-07
RC R1	0.000 E00			0.000 E00	0.000 E00	0.000 E00
RM R1	0.000 E00			0.000 E00	0.000 E00	0.000 E00
Line 1 - L1 - Power line						
RU R1	3.104 E-08			3.200 E-10	2.560 E-09	2.240 E-10
RV R1	1.391 E-05			1.280 E-05	1.024 E-06	8.960 E-08
RW R1	0.000 E00			0.000 E00	0.000 E00	0.000 E00
RZ R1	0.000 E00			0.000 E00	0.000 E00	0.000 E00
Line 2 - L2 - Telecom line						
RU R1	7.760 E-09			8.000 E-10	6.400 E-09	5.600 E-10
RV R1	3.478 E-05			3.200 E-05	2.560 E-06	2.240 E-07
RW R1	0.000 E00			0.000 E00	0.000 E00	0.000 E00
RZ R1	0.000 E00			0.000 E00	0.000 E00	0.000 E00

You are probably aware of the new International/European Standard IEC/EN 62305 for lightning protection, the second edition of which was published in 2012 in the UK. And you may be one of many, concerned about the complexity of calculations involved in identifying risk, in addition to what types of protection measures are now required.

Our latest risk software – StrikeRisk v6.0 – is an invaluable and effective tool for all those of you involved in working out risk to IEC/EN 62305 part 2. The purpose of our software is to enable you to carry out the complex, laborious calculations necessary for the implementation of parts 3 and 4 of the IEC/EN 62305 guidelines, with as much ease as possible. Results can be achieved in minutes rather than the hours or days that it would take to do the calculations by hand.

The screenshot displays the StrikeRisk v6.0.0.88 software interface. The 'Recent Projects' section is visible, showing a list of projects with their respective flags and titles. The projects listed are:

- BS EN 62305-2 [2012] Example NE6 - Heritage bu...
- BS EN 62305-2 [2012] Example NE7 - Bank compi...
- BS EN 62305-2 [2012] Example NE4 - Hospital.srp...
- IEC 62305-2 [2010] Example E3 - Office buildings...
- IEC 62305-2 [2010] Example E2 - Country house.s...
- TD7763_AMRC Factory 2050_BSEN_62305_2012_e...
- TD7763_AMRC Factory 2050_BSEN_62305_2006_e...

Choose from a number of pre-defined standards templates.

StrikeRisk v6.0 IEC/EN 62305-2 Protection Against Lightning Risk Management Software

Features and benefits

- Available in both single user (workstation) and multi-user (Network) versions
- Carry out and view multiple Cases (risk assessments) under the banner of a single project
- Build new projects from one of a number of pre-defined templates based on variants of IEC/EN 62305-2.
- Split the structure under consideration into multiple zones in order to pinpoint high risk areas
- Consider multiple cables connecting to the structure
- Consider multiple remotely connected structures
- Quick and easy colour coded identification of risk factors requiring attention
- Full detailed reporting/exporting facility
- Detailed online help

Intuitive interface

With our software, you will be able to assess the risk of loss due to lightning strikes and transient overvoltages caused by lightning.

Intuitive in design and using simple navigation tabs, you will be led through the process of defining the structures, lines, zones and protection measures that form each Case.

The ultimate aim of StrikeRisk is to automatically produce the results of your IEC/EN 62305-2 Risk management calculations in full or summary formats that can be passed to your customers or easily incorporated within the documentation of an engineering project.

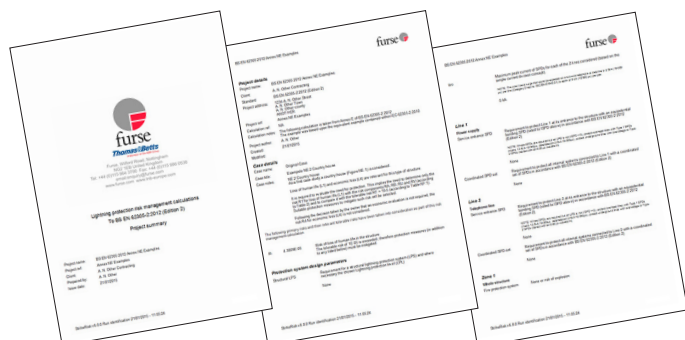

Making StrikeRisk work for you!

The heart of each StrikeRisk Project is in the production of Cases, each Case being a separate risk assessment in its own right. Once a Case has been defined, a series of calculations is carried out using relevant formulae to determine one or more of the four primary risks (R_x) for the Structure under review. These primary risks are:

- R_1 Loss of human life (including permanent injury)
- R_2 Loss of service to the public
- R_3 Loss of cultural heritage
- R_4 Loss of economic value (the structure, its contents and loss of activity)

Each calculated risk is then compared to its corresponding tolerable value (R_T). If the result shows $R_x \leq R_T$ then the Structure is adequately protected for a particular type of loss.

	Tolerable Risk	Calculated Risk	D
Risk of loss of human life	1.000 E-5	R1 5.839 E-6	=
Risk of loss of service to the public		R2	=
Risk of loss of cultural heritage	1.000 E-4	R3 2.354 E-4	=
Risk of loss of economic value		R4	=

If the result shows $R_x > R_T$ then the Structure is not adequately protected for the type of loss, therefore protection measures need to be applied.

These protection measures are determined from relevant tables given in IEC/EN 62305-2. These can be set within each Case. You can then simply use the software to test and apply a variety of protection measure solutions to reduce the risk of R_x below that of R_T .

StrikeRisk v6.0 IEC/EN 62305-2 Protection Against Lightning Risk Management Software

Licensing options

Description	Workstation licence	Network licence	Part No.
Single user copy	✓	-	SR600
Dual user copy	-	✓	SR602
10 user copy	-	✓	SR610
Fixed user copy	-	✓	SR699

For number of network license users greater than 10, choose Fixed User Copy and contact Furse to discuss your requirements.

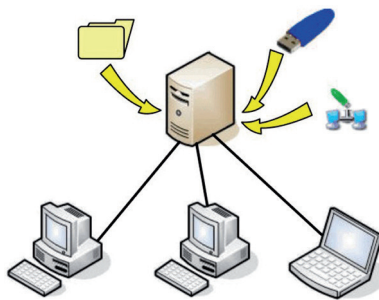

Network license

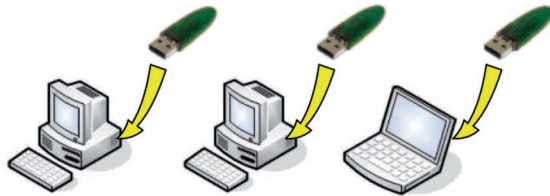

Workstation license

System requirements

Before installing StrikeRisk v6.0 make sure your PC meets the following minimum requirements. You need...

Software

- Microsoft .NET Framework 4.5 (installed with StrikeRisk) or Microsoft .NET Framework 4.51.

Hardware Requirements

(as per Microsoft .NET Framework 4.5)

- Processor 1GHz
- RAM 512MB
- Disk space (minimum) 32-bit 850MB, 64-bit 2GB

Supported client operating systems

- Windows 8.1 32-bit and 64-bit Include the .NET Framework 4.5.1
- Windows 8 32-bit and 64-bit Include the .NET Framework 4.5
- Windows 7 SP1 32-bit and 64-bit
- Windows Vista SP2 32-bit and 64-bit

For all platforms, we recommend that you upgrade to the latest Windows Service Pack and critical updates available from the Windows Update website to ensure the best compatibility and security.

Don't leave it until its too late!

Our commercially available software is here so get hold of your copy from us today! Call us on 0115 964 3700 to discuss your requirements in more detail or visit www.furse.com and download your free 15 day trial.



Contact us

Furse

Wilford Road
Nottingham NG2 1EB
United Kingdom
Switchboard: +44 (0) 115 964 3700
Fax: +44 (0) 115 986 0538
Sales Tel: +44 (0) 115 964 3800
Sales Fax: +44 (0) 115 986 0071
Email: enquiry@furse.com

www.furse.com

Note: We reserve the right to make technical changes or modify the contents of this document without prior notice. With regard to purchase orders, the agreed particulars shall prevail. Furse does not accept any responsibility whatsoever for potential errors or possible lack of information in this document.

We reserve all rights in this document and in the subject matter and illustrations contained therein. Any reproduction, disclosure to third parties or utilization of its contents - in whole or in parts - is forbidden without prior written consent of Furse.

Copyright © 2015 Furse
All rights reserved

© Furse SPMDS 01/2015