

Wye Solar LED 10 Light Festoon

Item ref: 42229

User Manual

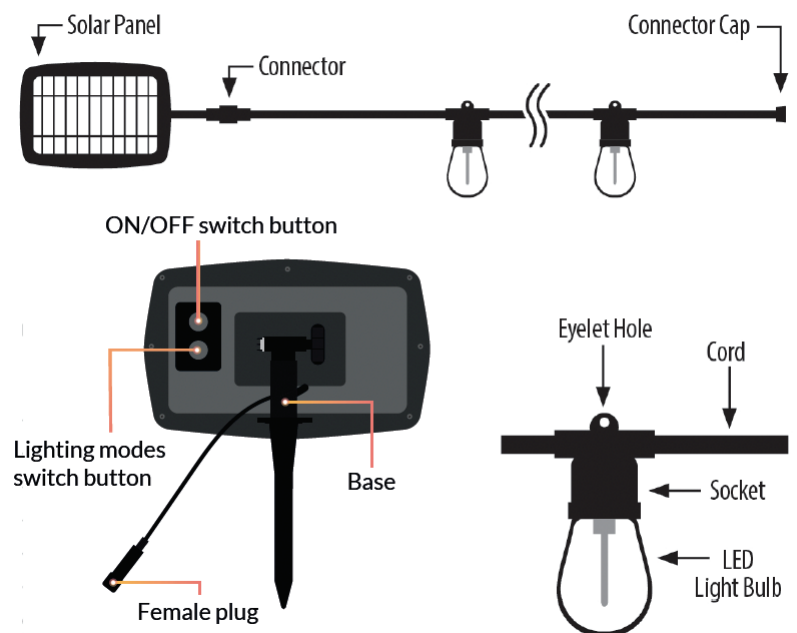

- Suitable for OUTDOOR USE ONLY - IP44 rated
- Easy to install, no wiring necessary
- Recharges batteries using solar energy
- Automatically charges in sunlight

Installation

- When using for the first time, the solar light needs to charge in full sunlight for a full day or using the Micro USB supplied. The battery needs to be fully charged/discharged once per month. For best performance and battery life, do not store for prolonged periods.
- Ensure the light is positioned in a bright sunny location where it will receive maximum sunlight. Ideally, in a position where it is free from cover and not in a shaded area. Lack of sunlight will affect charge times and operation.
- Avoid other light sources such as street lamps that may cause the solar lights to flicker on and off.
- Assembling the lamp:

Option 1. Spike mounted solar unit:

1. Insert the spike onto the solar unit and locate it as mentioned above.
2. Connect the open end of the festoon to the female plug.
3. Insert the 10 x S14 0.5W E27 LED bulbs (supplied)
4. Hang the festoon.

Option 2. Wall/Rail mounted solar unit:

1. Mount the solar unit using mounting screws and locate it as mentioned above.
2. Connect the open end of the festoon to the female plug.
3. Insert the 10 x S14 0.5W E27 LED bulbs (supplied)
4. Hang the festoon.



The festoon can also be powered by connecting the USB lead to an appropriate power source.

Warnings

- Suitable for OUTDOOR USE ONLY
- DO NOT expose this product to direct heat, flames or immerse in water.
- Keep out of reach of children and pets.
- Please retain this information for future reference.
- Do not attempt to connect solar strings end to end.
- Do not operate with missing bulbs.
- Do not hang objects from the string light.

Cleaning

- If the solar panel gets dirty the charging capacity will be reduced. Clean panels occasionally with a soft damp cloth.

Troubleshooting

Night runtime is short

The battery is not fully charged. Install the solar light in an area where it can receive the maximum amount of direct sunlight.

Light does not turn on at night

The location is too close to other light sources. Relocate the light away from other light sources.

Made in China for ZINK, Gorse Mill, Gorse Street, Oldham, OL9 9RJ, U.K.

Helpline: 0333 005 0077, Mon-Fri, 9am-5pm.

UK MANUFACTURER / IMPORTER
CASCADE HOLDINGS LTD.
GORSE MILL
GORSE STREET
OLDHAM,
UNITED KINGDOM
OL9 9RJ



EU AUTHORISED REPRESENTATIVE:
AUTHORISED REP COMPLIANCE
GROUND FLOOR
71 LOWER BAGGOT STREET
DUBLIN
IRELAND
D02 P593



Disposal: The "Crossed Wheelee Bin" symbol on the product means that the product is classed as Electrical or Electronic equipment and should not be disposed with other household or commercial waste at the end of its useful life. The goods must be disposed of according to your local council guidelines.