

Product Code: QCT25-10

Description: 25mm<sup>2</sup> Copper Tube Lug With 10mm Stud

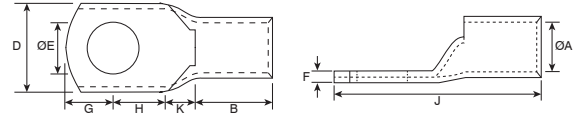

**Dimensions (mm)**

ØA	B	D	ØE	F	G	J	K
7	15	17.5	10.5	1.5	10	39	4

**Materials**

Tin Plated Copper Tube

**General Information**

Conductor Cable Size	25mm <sup>2</sup>
Fixing Type	Suitable for crimp or solder
Inspection Window	Yes
Contact Plating	5 to 8 Microns
Flared Entry	Yes
Conductivity	97% to IACS
Working Temperature	Up to 180°C

**Additional Information**

When using flexible fine strand or welding cable it may be necessary to select the next larger terminal size, i.e 70mm<sup>2</sup> fine strand, select 95mm<sup>2</sup> terminal.

**Packaging Overview**

Polybag Of 5 Lugs

**Standards**

ANSI/UL 486A-486B, CAN/CSA-C22.2 No. 65  
ANSI/UL 486C, CSA-C22.2 No. 188  
Tensile performance requirements to IEC 61238-1-1: 2018

**Directives**

Low Voltage Directive: 2014/35/EU  
RoHS 2: 2011/65/EU & RoHS 3: 2015/863/EU  
REACH: 1907/2006/EU

