

Product Code: QBR10

Description: 10mm Stud Ring Terminals - Blue

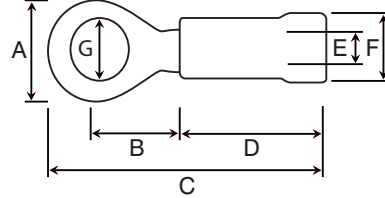

**Dimensions (mm)**

A	B	C	D	E	F	G
13.6	13.9	30.5	10	2.3	4.8	10.6

**Materials**

Terminal: Tin Plated Copper

Insulation: PVC

**General Information**

Insulation Colour:	Blue
Conductor Cable Size Range	1.5 - 2.5mm <sup>2</sup>
Current Rating (Max)	24A
Voltage (Max)	600V
Temperature Rating	-10°C - +75°C

**Packaging Overview**

Polybag Of 100 Terminals

**Standards**

ANSI/UL 486A-486B, CAN/CSA-C22.2 No. 65

ANSI/UL 486C, CSA-C22.2 No. 188

ANSI/UL 310, CSA-C22.2 No. 153

**Directives**

Low Voltage Directive: 2014/35/EU

RoHS 2: 2011/65/EU & RoHS 3: 2015/863/EU

REACH: 1907/2006/EU

