

Product Code: QCT16-10

Description: 16mm² Copper Tube Lug With 10mm Stud

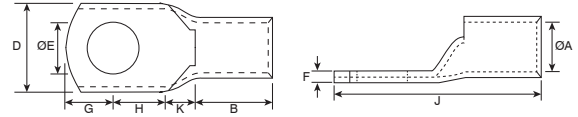

Dimensions (mm)

ØA	B	D	ØE	F	G	J	K
5.5	15	19	10.3	1.8	10	39	4

Materials

Tin Plated Copper Tube

General Information

Conductor Cable Size	16mm ²
Fixing Type	Suitable for crimp or solder
Inspection Window	Yes
Contact Plating	5 to 8 Microns
Flared Entry	Yes
Conductivity	97% to IACS
Working Temperature	Up to 180°C

Additional Information

When using flexible fine strand or welding cable it may be necessary to select the next larger terminal size, i.e 70mm² fine strand, select 95mm² terminal.

Packaging Overview

Polybag Of 10 Lugs

Standards

ANSI/UL 486A-486B, CAN/CSA-C22.2 No. 65
ANSI/UL 486C, CSA-C22.2 No. 188
Tensile performance requirements to IEC 61238-1-1: 2018

Directives

Low Voltage Directive: 2014/35/EU
RoHS 2: 2011/65/EU & RoHS 3: 2015/863/EU
REACH: 1907/2006/EU

