



INSTALLATION & MAINTENANCE MANUAL

**OPRCDKIT**

## GENERAL INSTRUCTIONS

**These instructions should be read carefully and retained after installation by the end user for future reference and maintenance.**

**These instructions should be used to aid installation of the following product:  
OPRCDKIT**

## SAFETY

- This product must be installed in accordance with the latest edition of the IEE Wiring Regulations (BS7671) and current Building Regulations. If in any doubt, consult a qualified electrician
- Please isolate mains prior to installation or maintenance
- Check the total load on the circuit (including when this product is fitted) does not exceed the rating of the circuit cable, fuse or circuit breaker
- Please note the IP (Ingress Protection) rating of this product when deciding the location for installation
- Do not overload this accessory or subject it to conditions outside its rating
- This product is Class I and must be earthed
- This product is IP66 rated (outdoor socket outlet) / IP20 rated (RCD plug)

## INSTALLATION

- Choose a suitable position for the outdoor socket outlet. It should be fixed to a rigid flat surface as unevenness could cause damage to the product or affect operation
- Choose a suitable location close to the socket outlet to bring the supply cable through the wall to inside the building
- Drill a suitable hole through the wall, ensuring not to infringe with any gas/water pipes or electrical cables. The hole should slope very slightly down towards the outside in order to prevent water ingress through the wall
- Remove the socket outlet front assembly from the backbox and carefully lift off the gasket. Drill the required number of fixing holes in the backbox (see Fig. 1)
- Using the backbox as a template, mark the location for, and drill the fixing holes ensuring not to infringe with any gas/water pipes or electrical cables

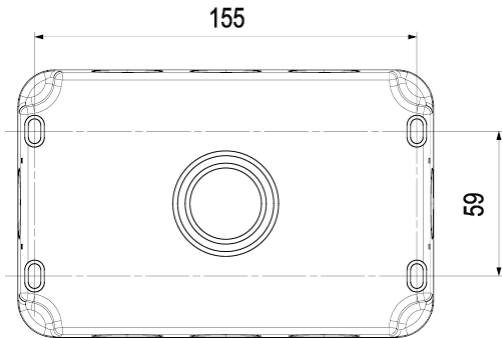

**Fig. 1**

- The backbox has drain hole drilling guides marked (see Fig. 2). Drilling a drain hole is advised if the unit is installed in a location subject to temperature fluctuations where build-up of condensation may occur. It is not advised if the unit will be subject to spray or jets, as drilling a drain hole will reduce the IP rating. A 3-5mm hole can be drilled at the bottom back edge of the enclosure where marked

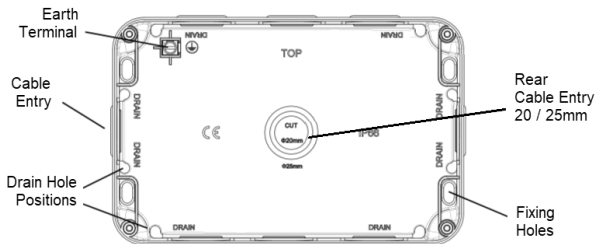

**Fig. 2**

- Remove one of the pre-fitted blank plugs as required by pushing out from the inside. Remove the lock ring from the IP66 gland, insert the gland through the hole, screw the lock ring onto the gland and tighten. Any unused cable entries must have the blank plugs fitted
- Feed the mains cable into the unit and tighten the gland onto the cable
- Secure the baseplate to the surface. The fixing holes are slotted to allow some rotational adjustment
- Replace the gasket onto the backbox, then wire as shown in Fig. 3 ensuring the correct polarity is observed: L - Live (brown), E - Earth (green/yellow), N - Neutral (blue)

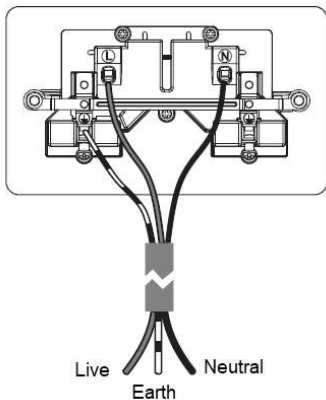

**Fig. 3**

- An earth connection must be made to the earth terminal of the socket. The earth terminal in the backbox is provided for convenience and does not need to be connected
- Check all electrical connections are secure with no loose strands of cable
- Ensuring the gasket does not become damaged or pinched, fit the socket assembly onto the backbox, taking care not to compress, damage or trap any cables, and secure with the screws provided - do not overtighten
- Fit screw covers
- Pass the cable through the wall and cut to suitable length if required
- Remove the terminal cover from the RCD plug and wire as shown in Fig. 4 ensuring the correct polarity is observed: L - Live (brown), E - Earth (green/yellow), N - Neutral (blue)

Following a power cut the RCD will automatically reset itself and does not need manually resetting. Care should be taken to avoid connected loads powering up without warning.

The TEST button should be pressed at regular intervals to check the RCD is functioning correctly. We recommend testing every 3 months. If the red indicator does not turn black when the TEST button is pressed, do not use.

The RCD plug is fitted with a 13A fuse to BS1362. To replace the fuse, gently prise open the fuse carrier with a small flat-bladed screwdriver.

## **WARNING**

To ensure continued safe and proper weatherproof operation, the unit must not be left with the cover raised open or the catch left unlocked.

This product must be disconnected from the circuit if subjected to any high voltage or insulation resistance testing. Irreparable damage will occur if this instruction is not followed.

## **GENERAL**

This product should be recycled in the correct manner when it reaches the end of its life. Check local authorities for where facilities exist.

To clean the external surfaces, securely close the cover and use a damp cloth with a mild solution of detergent and warm water only, do not use aggressive cleaning products or solvents which may damage the product. If it is necessary to clean inside the cover, use a soft dry cloth only.

Do not use any source of high-pressure washers to maintain or clean this product.

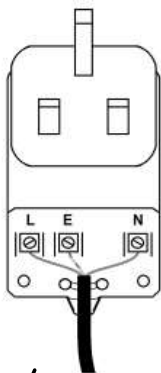

**Fig. 4**

- Secure the cable with the cord grip provided
- Close the terminal cover and fasten with the screws provided
- Plug the RCD plug into a socket outlet, switch on and check for correct operation. See below for operation of the RCD

For security, and to prevent unwanted tampering with the socket outlet, a lug feature with a 6mm hole is provided to accept a padlock or similar locking security device (not included).

**Note:** The power indicator is lit when there is power to the unit and the switch is on, irrespective of whether a load is plugged in or not.

## RCD TEST PROCEDURE

When the RCD is first plugged in, press the green RESET button to switch on the supply to the socket. The red indicator should appear.

To test that the RCD is operating correctly, press the blue TEST button. The red indicator should turn black and power to the socket should be disconnected.

To restore power, press the green RESET button. The red indicator should reappear.

If the RCD should trip due to a fault, the RESET button can be pressed after the fault is rectified. If the RCD will not reset, remove any connected loads from the socket outlet and check for water ingress or damage.

## WARRANTY

This product has a warranty of 1 year from date of purchase. Failure to install this product in accordance with the current edition of the IEE Wiring Regulations (BS7671), improper use, or removal of the batch code will invalidate the warranty. If this product should fail within its warranty period it should be returned to the place of purchase for a free of charge replacement. ML Accessories does not accept responsibility for any installation costs associated with the replacement product. Your statutory rights are not affected. ML Accessories reserve the right to alter product specification without prior notice.



**ML**  
ACCESSORIES LTD



**ML Accessories Limited LU5 4LT**  
**[www.mlaccessories.co.uk](http://www.mlaccessories.co.uk)**