

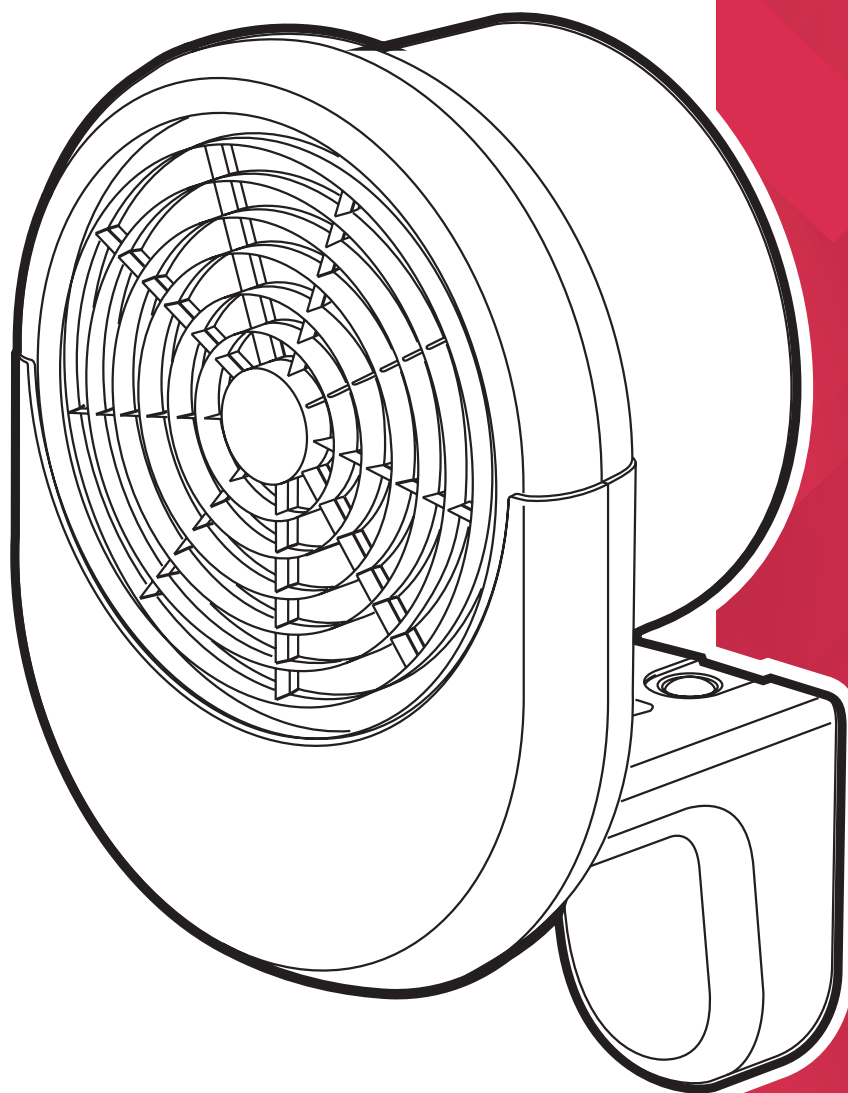

# INSTRUCTION MANUAL

Installation and Operating



## Garage Fan Heater

Model: PFH30E

This product is supplied and operated with a Bluetooth Remote Control handset



## IMPORTANT

THESE INSTRUCTIONS SHOULD BE READ CAREFULLY AND RETAINED FOR FUTURE REFERENCE. **Note also the information presented on the appliance**

### IMPORTANT SAFETY ADVICE

**DO NOT** use the heater in the immediate surroundings of a bath, a shower or a swimming pool.

**DO NOT** place the heater directly below a fixed socket outlet.

**DO NOT** use the heater for continuous space heating.

**DO NOT COVER** or obstruct the air inlet and outlet openings in any way.

**DO NOT** operate the heater with the mains lead overhanging the front outlet grille.

**WARNING:** In order to avoid overheating **DO NOT COVER** or obstruct the air inlet and outlet openings in any way.

**IMPORTANT:** If the mains lead of this appliance is damaged, it must be replaced by the manufacturer or its service agent or a similarly qualified person in order to avoid a hazard.

**WARNING:** In order to avoid a hazard due to inadvertent resetting of the thermal cut-out, this appliance must not be supplied through an external switching device, such as a timer, or connected to a circuit that is regularly switched on and off by the utility.

This appliance can be used by children aged from 8 years and above and persons with reduced physical, sensory or mental capabilities or lack of experience or knowledge if they have been given supervision or instruction concerning the use of the appliance in a safe way and understand the hazards involved. Children shall not play with the appliance. Cleaning and user maintenance shall not be made by children without supervision.

Children of less than 3 years should be kept away unless continuously supervised. Children aged from 3 years and less than 8 years shall only switch on/off the appliance provided that it has been placed or installed in its intended normal operating position and they have been given supervision or instruction concerning the use of the appliance in a safe way and understand the hazards involved. Children aged from 3 years and less than 8 years shall not plug in, regulate and clean the appliance or perform user maintenance.

**CAUTION:** Some parts of this product can become very hot and cause burns. Particular attention has to be given where children and vulnerable people are present.

**CAUTION:** The instruction leaflet belongs to the appliance and must be kept in a safe place. If changing owners, the leaflet must be surrendered to the new owner.

Always disconnect the supply before working on the product.

Always ensure combustible materials such as drapes or other furnishings are kept clear of the air inlet and air outlet.

This product should be mounted vertically and securely fixed to a solid wall location at a minimum height of 1.8m.

**WARNING:** The supply circuit to the heater must incorporate a double pole isolating switch having a contact separation of at least 3mm in all poles.

Ensure the supply cables are of adequate current carrying capacity and are protected by a suitable fuse.

**WARNING: KEEP BATTERIES OUT OF REACH OF CHILDREN**

- Swallowing may lead to serious injury in as little as 2 hours or death, due to chemical burns and potential perforation of the oesophagus.
- If you suspect your child has swallowed or inserted a battery go straight to a hospital emergency room.
- Examine devices and make sure the battery compartment is correctly secured, i.e. that the battery cover is fitted securely. Do not use if the compartment is not secure.
- Dispose of used batteries immediately and safely. Flat batteries can still be dangerous.

# Energy Related Product Directive

This product complies with Lot20 of the Energy Efficiency Directive (2015/1188).

Type of heat output/ room temperature control	
Electronic room temperature control plus week timer	Yes
With open window detection	No
With adaptive start control	Yes

## Technical Details

Model Identifier(s):		PFH30E
Nominal heat output	P <sub>nom</sub>	3.0 kW
Height (mm)		378
Width (mm)		230
Depth (mm)		226
Minimum heat output (indicative)	P <sub>min</sub>	1.5kW
Maximum continuous heat output	P <sub>max,c</sub>	3.0kW
Auxiliary electricity Consumption		
At nominal heat output	e <sub>lmax</sub>	0.00
At minimum heat output	e <sub>lmin</sub>	0.00
In standby mode	e <sub>lSB</sub>	<0.0005

## All Models

Controls	Digitally controlled, Electronic Thermostat Timer modes: 7 Day Programmable User Timer Continuous heat modes: Frost Protect, Runback, Fan Only, Comfort Off
Controller UI	Button to initiate pairing with Bluetooth remote
Controller Functions	<ul style="list-style-type: none"> <li>• Heat Selection: High, Low, Fan Only</li> <li>• Adaptive-Start</li> <li>• Advance time period</li> <li>• Adjustable SP range (7-30°C)</li> <li>• Bluetooth for control</li> </ul>
Construction	Injection moulded PA6 nylon chassis, connected via ball and socket wall fixing bracket
Fan Type	Axial
Element	2 stage radial stitched element (1500/1500)
Installation	Supplied with wall mounting bracket. Wall bracket allowing 120° adjustment horizontally, 40° vertically
Safety	Thermal cut-out. Electrical reset type over-heat detection
IP Rating	No Rating
Battery Backup	None. However all programmed timer profiles will be retained during short term power losses. In order to ensure their correct operation, it is necessary to restore the time and date settings, this happens automatically once paired with the remote.
Supply	-230-240 V, 50Hz Class II
Colour / Finish	Grey
Approvals	CE, BEAB
Warranty	2 years
Country of Origin	British Isles
Manufacturer	Glen Dimplex Heating & Ventilation (GDC Group Ltd.)

Fig. 1

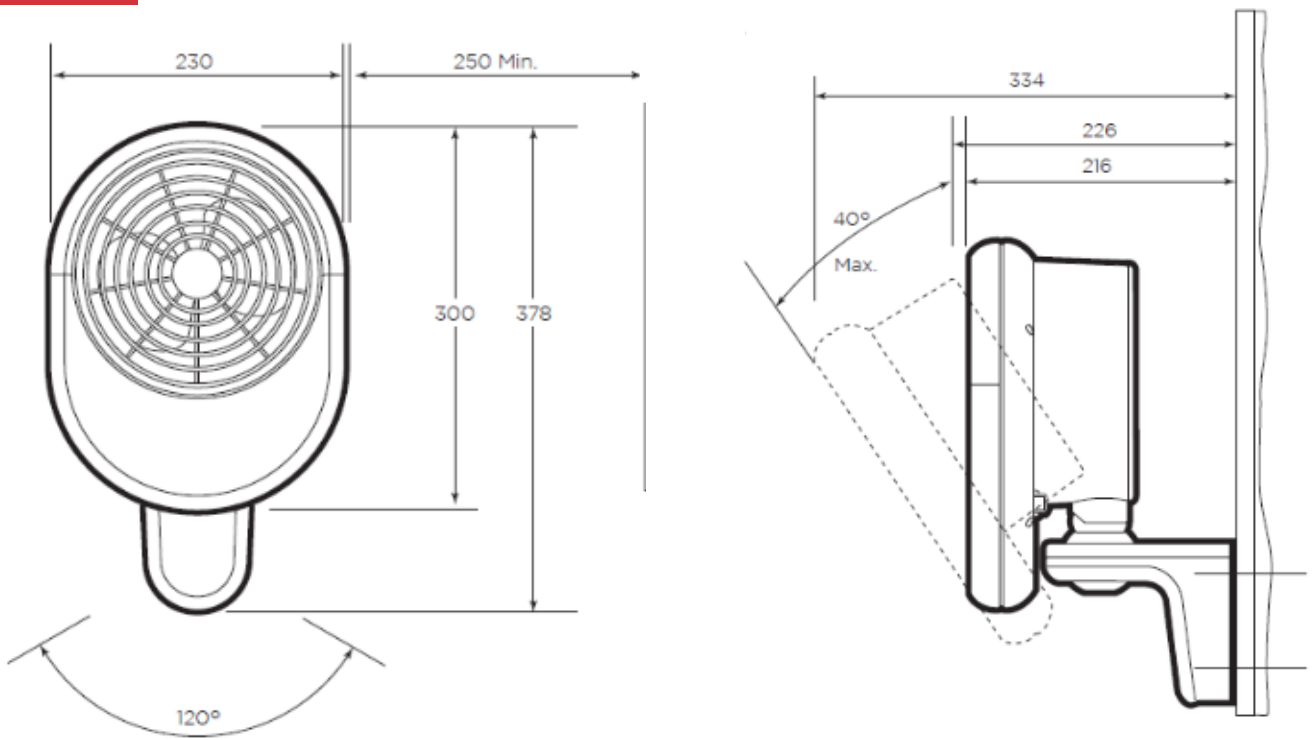

Fig. 2

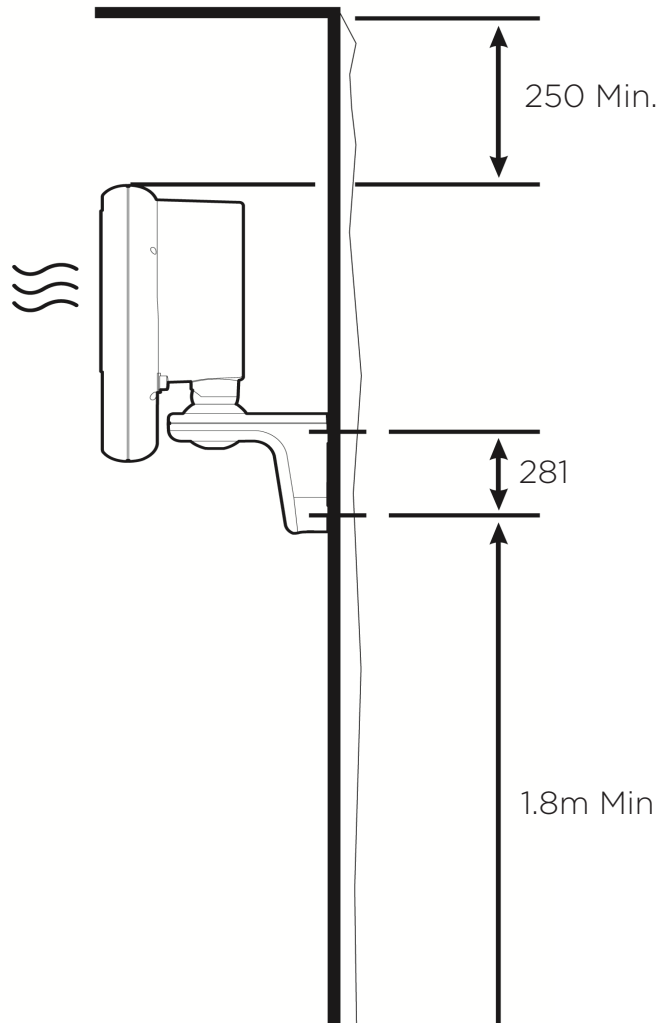
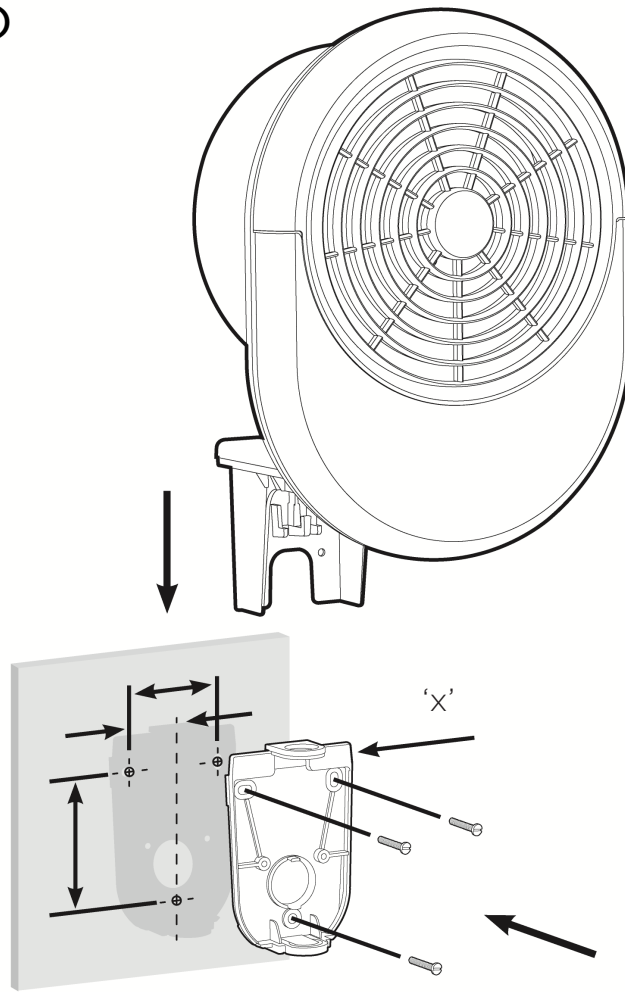
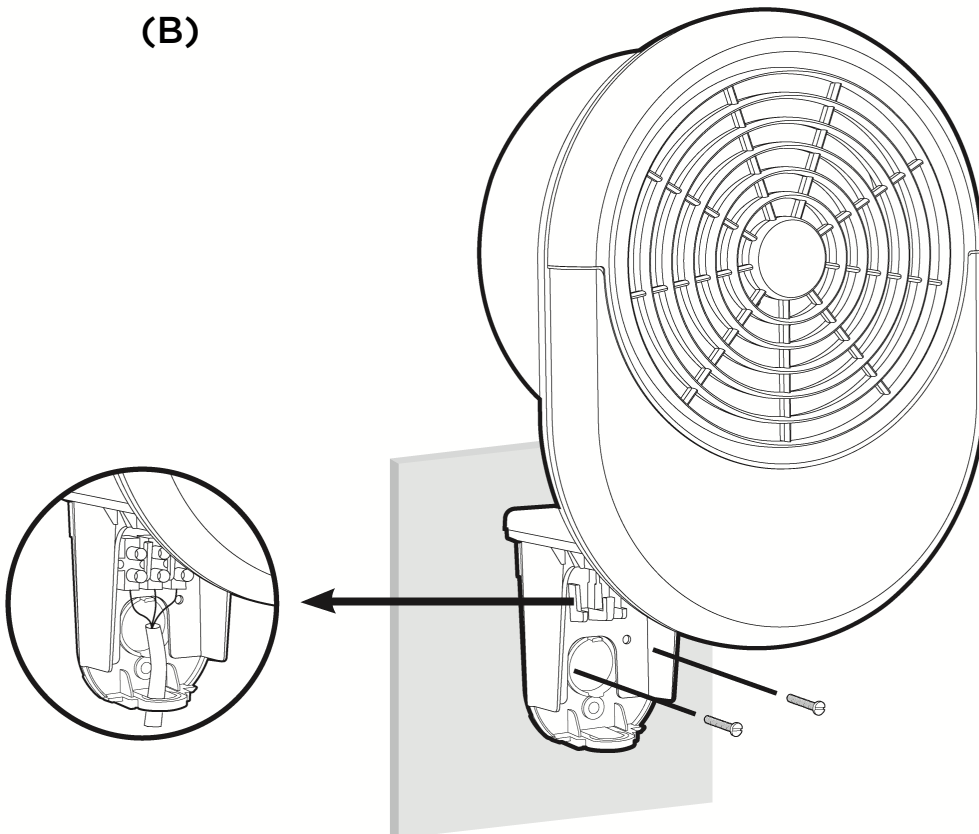

Fig. 3

(A)



(B)



(C)

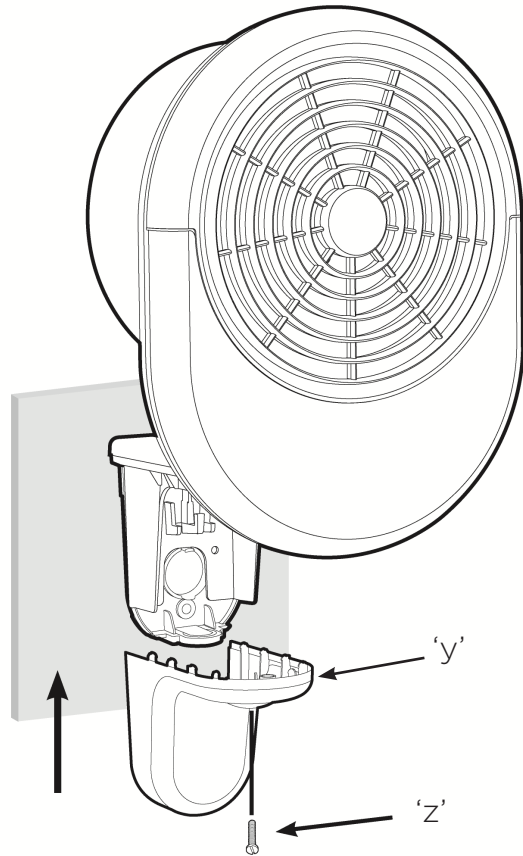
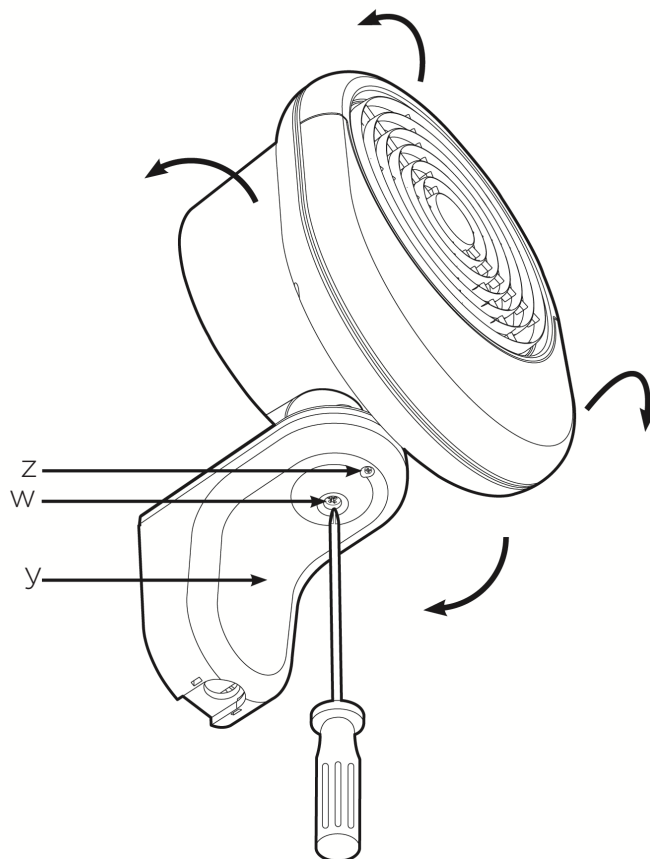

Fig. 4





## General

This heater is designed to provide intermittent spot heating for small domestic environments such as garages and workshops.

The heater works by gradually raising the air temperature in a garage or workshop and should be positioned above head height approximately 1.8m - 2.3m - (see **Fig. 2**).

The PFH30E heater has an output of 3kW.

The angle the appliance is mounted at may be adjusted horizontally and vertically - see **Fig. 1** and **Fig. 4**.

## Electrical

The installation of this appliance should be carried out by a competent electrician and be in accordance with the current IEE wiring regulations. The supply cable is not supplied with the appliance.

Before undertaking electrical installation, ensure the electricity supply is disconnected from any relevant fixed wiring.

With the bracket cover removed proceed to feed the supply cord through the cable entry at the bottom of the mounting bracket (drill knock-out to suit). Connect the wires to proper live and neutral of the internal terminal block.

## Wall Mounting

- Remove the screw (see 'z' in **Fig. 3C**) to remove the cover bracket.
- Use the wall mounting bracket (see 'x' in **Fig. 3A**) as a guide to mark the hole positions on a suitable wall (a minimum height of 1.8 metres is required from the floor level to the bottom hole of the bracket - see **Fig. 2**).
- Solid brick or concrete block walls must be drilled and plugged using the screws and wall plugs provided. Fix the wall mounting bracket to the wall and slide the heater down on to the bracket as shown in **Fig. 3A**.



**NOTE:**

*Ensure there is enough clearance above the wall mounting bracket for the user to slide the heater onto the bracket*

- The heater is held in place to the wall mounting bracket with 2 screws - see **Fig. 3B**.
- Once electrical connections have been completed - see 'Electrical Installation', re-attach the bracket cover (see 'y' in **Fig. 3C**) by sliding into place and secure with the screw - see 'z' in **Fig. 3C**.
- Pivot and rotate the heater into the desired position and tighten the screw to secure - see 'w' in **Fig. 4**.

# Remote Control

The product is supplied with a Bluetooth remote control which should be contained in the carrier bag along with these instructions. This remote control is required to operate the appliance. When paired with the remote control various operational modes and features can be accessed.



## IMPORTANT NOTE:

*The remote control is required to operate the appliance. It is important that the remote control remains near the appliance at all times.*

- 1 Display Screen
- 2 'Menu' Button
- 3 'Back' Button
- 4 'Advance' Button
- 5 'Up and Down' Arrows
- 6 'Enter' Button

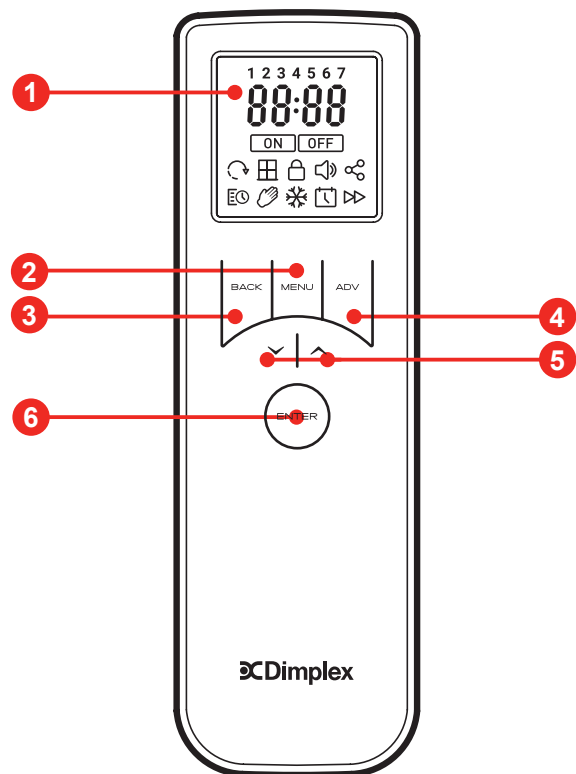

## Fitting the Batteries:

The remote requires two AA batteries. These are supplied with the product contained in the bag along with the instructions and remote.

To fit the batteries:

1. On the rear of the remote, remove the battery cover by pushing the catch downwards and pulling outwards in one motion.
2. It should be possible to completely remove the battery cover to reveal the battery cavity.
3. Carefully insert the new batteries, ensuring the polarity is correct. Ensure the '+' and '-' signs on the batteries match the signs marked inside the battery cavity.

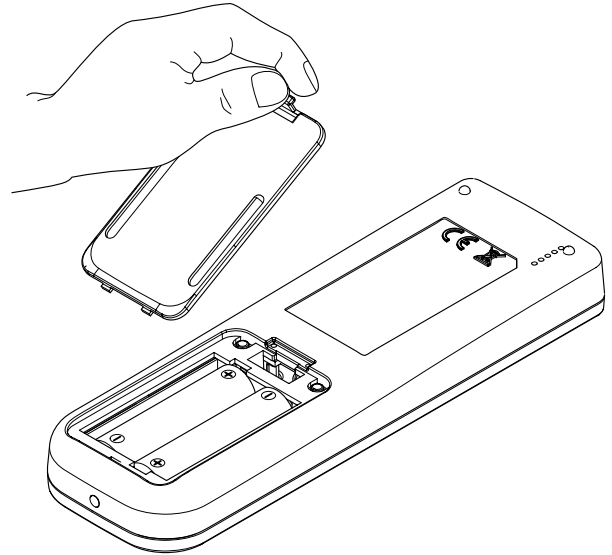

4. Once the batteries are in place, replace the cover, ensuring the clip has engaged fully.

Once the batteries have been successfully fitted the remote control will immediately start scanning for a product to control. At this stage it is necessary to complete the pairing process, see *Remote Pairing Instructions*.

## Remote control cradle:

The remote control is supplied with a wall mounting cradle. If desired, mount the cradle in a suitable location. The cradle can be mounted using suitable screws and the appropriate wall fixing solution, not supplied.

Mark and drill the wall accordingly to mount the remote control cradle. The remote control can also be fixed to the cradle using the bottom fixing screw. The use of this screw is optional, particularly if the remote will be used as a portable device.

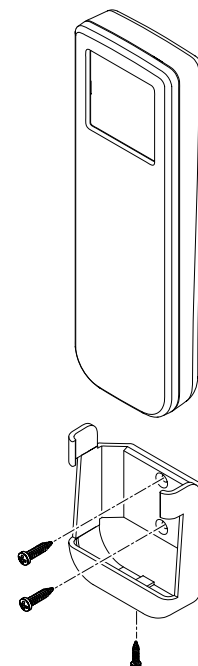

### NOTE:

If the remote cradle is not initially required please store in a suitable location in case of future use. The bottom fixing screw should also be stored with the cradle

# Remote Pairing Instructions

To pair the product to the Bluetooth remote:

1. Press the Bluetooth button which is located on the back of the product. The product will emit a beep and begin to broadcast a signal to be paired via Bluetooth.



**NOTE:**

*If no remote pairs within 2 minutes, the product will stop broadcasting.*

2. Wake the remote by briefly holding the **ENTER** button.

Once awake the remote will then immediately search for the product. This is indicated by the rotating loading graphic and flashing connectivity icon. on the remote followed by the pairing sequence.

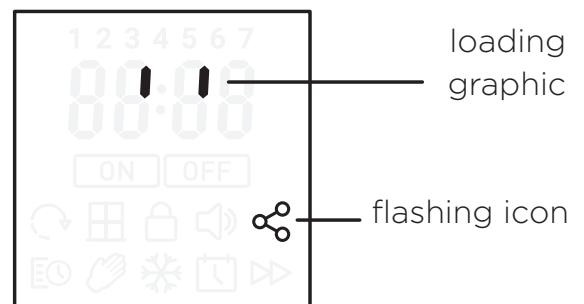

**NOTE:**

*The remote will attempt to pair with the first product it finds. Please ensure that no other products are broadcasting within the vicinity to prevent pairing to the incorrect product.*

3. The remote will search for devices for 1 minute. If no product can be found, the remote will display 'NO PROD' before returning to a sleep state. If this happens, please repeat steps 1 and 2.
4. If connection is successful the product will emit a second beep and the remote screen will show a solid connectivity icon for 4 seconds then revert to the home screen.

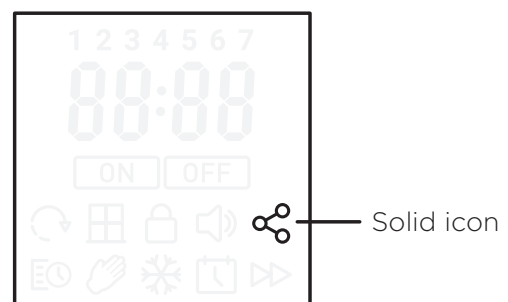

**NOTE:**

*After initial pairing the Time and Date must be set before the remote will revert to the home screen.*



## Setting Time & Date

After initial remote control start up and after replacing the batteries it is required to set the time and date. It is not possible to navigate to the home screen and product settings until the time and date have been set.

It is possible to modify these settings at any stage from within the menu structure, see **page 19**.

### Setting Time

It is required to set the hour and minute digits independantly.

1. The first digit of the Hour setting will be blinking. Use the arrow key to set the first digit of the time.
2. Confirm the selection by pressing the **ENTER** button, the second digit of the Hour can then be set.
3. Once the hour digits have been set and confirmed, step 1 & 2 should be repeated to set the minute.

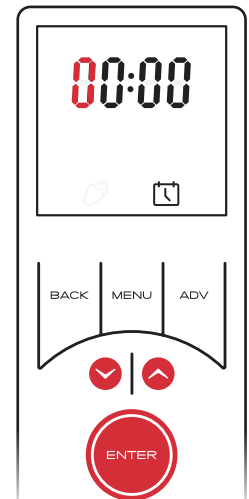

### Setting Date

Once the time has been set the remote will automatically move to the date setting.

1. After confirming the last time digit 'Day' will blink three times and then change to a two digit number with the first digit blinking. This two digit number represents the day of the month.
2. Use the arrow key to set the first digit of the date and confirm using the **ENTER** button.
3. The second digit will then blink and can be set as per step 2.
4. After the day has been confirmed it is necessary to set the month, this is indicated by '1-12' blinking on the screen.
5. A numerical value for the month can be set using steps 2 & 3 above.
6. Once the month has been set the year can be set. Each digit must be set and confirmed individually.
7. Finally the remote will offer an option to turn on or off day light saving settings. 'On' and 'Off' can be selected using the arrow keys and confirmed by pressing enter.

Once the time and date have been set the remote will revert to the home screen and normal operation can resume.

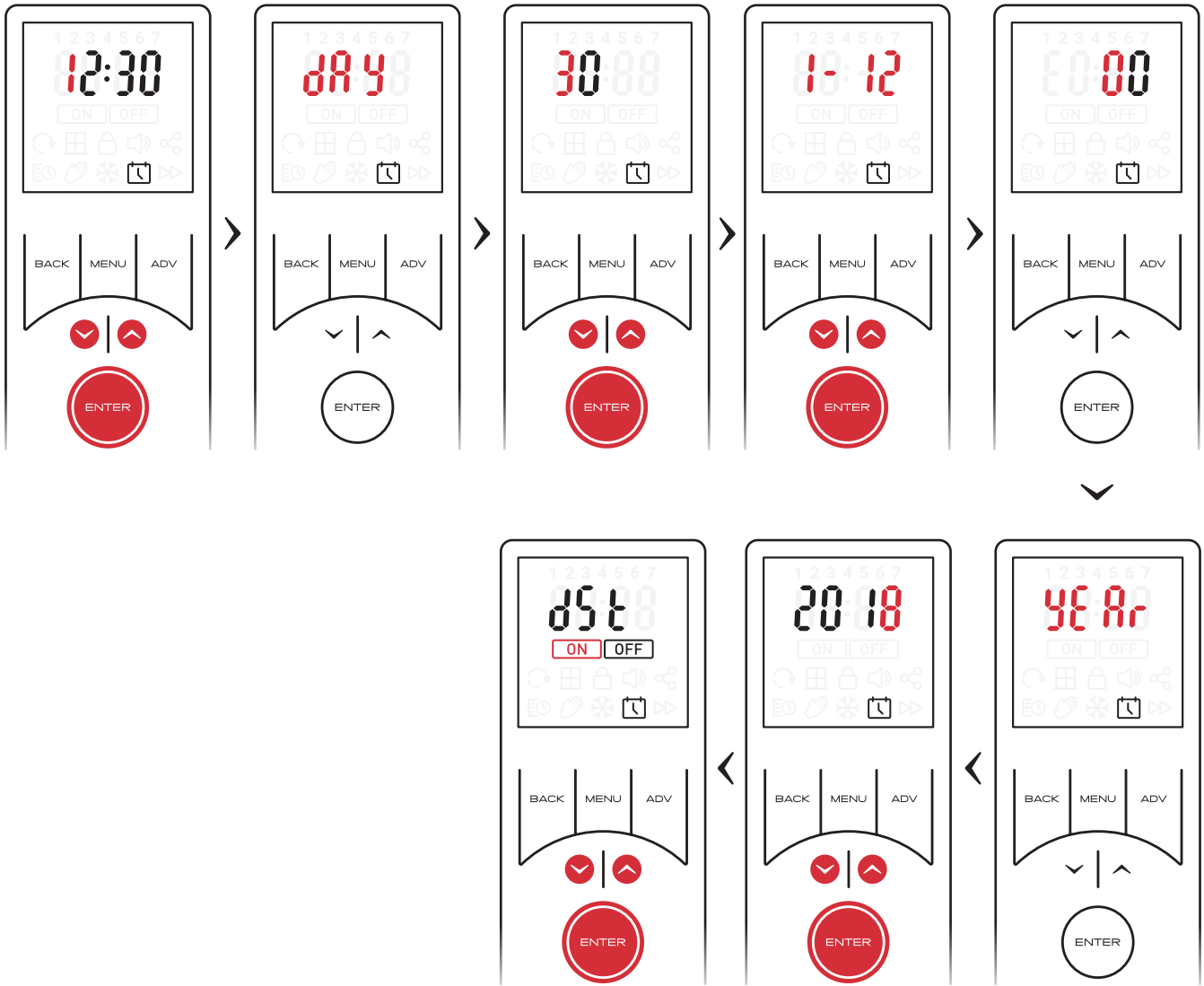

# Operation

The product is controlled using the remote control. The remote consists of a display screen and six touch sensitive buttons. The function of each button and the meaning of each screen icon is explained in the graphic below. The remote offers fully programmable time and temperature control with a host of additional useful control features.

It is possible to control the appliance in various operational modes including Manual operation mode, User timer and frost protection mode. There are also advanced operating modes such as a runback mode and also a landlord PIN protected function. .

## Button Functions

- 1. MENU** - enters the main product menu.
- 2. ENTER** - used to confirm selections & settings.
- 3. BACK** - returns to the previous screen. If held for 2 seconds, the heater will enter Comfort Off mode.
- 4 & 5. Arrow keys** - used to navigate through the menus and adjust the room temperature set-point.
- 6. ADV** - use depends on the active mode and settings, typically used to advance the program in timer mode or to initiate a runback period in Manual/ PIN mode.

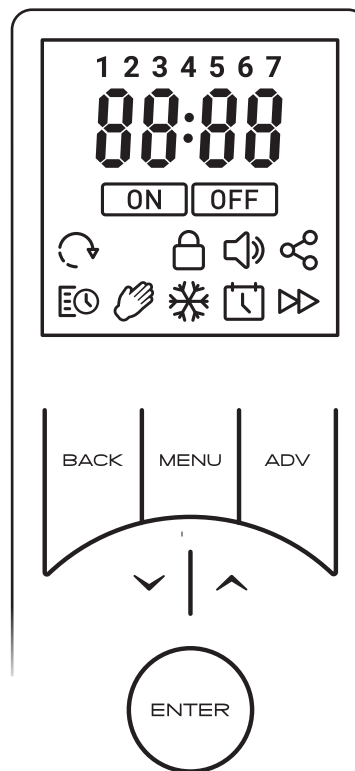

### Symbol Key

- ON** Heating On
- OFF** Heating Off
- Adaptive Start
- Timer Schedule
- Manual Mode
- Frost Protection
- Connectivity
- Pin Lock
- Advance
- Set Time & Date
- 1 2 3 4 5 6 7** Days of the week
- 88:88** Time Numerals

## Advanced button functions & Shortcut keys

**Comfort Off** - Press and hold **BACK** for 2 seconds

**Temp Settings** - Press and hold **MENU** for 2 seconds

**Heating Settings** - Press and hold **ADV** for 2 seconds

**Service Info** - Press and hold **ENTER** for 2 seconds

**Advance Menu** - Press and hold both **MENU** and **ADV** for 2 seconds

**Factory Reset** - Press and hold both and for 5 seconds



### NOTE:

All setting changes and communications between the remote control and the appliance are signified with an audible 'beep' from the appliance. This beep signifies that connection is successful and the appliance has received a command from the remote control.



## Waking from Standby Mode

When in standby mode, holding **ENTER** for two seconds will wake the remote and attempt to reconnect to the product, this will be signified by the connectivity icon and loading graphic appearing on the screen.

## Operating Modes

The remote control provides the option of a number of standard control modes,

- **Timer Mode:** provides the greatest flexibility to the user. Four heating periods are available throughout each day and these can be customised for every day of the week. The desired set temperature can be set for each time slot independently
- **Manual Mode:** Maintains the displayed temperature for an undetermined period. The default 'comfort' temperature in manual mode is set to 21°C however this can be adjusted to suit.
- **Frost Protect:** maintains a room temperature of 7°C. This mode should be used to provide protection against frost.
- **Comfort Off:** no room temperature control

There are also a number of advanced control options and features available

- **Runback Mode:** This is an additional feature available to manual mode, with this mode active the manual mode will operate for a determined time period and then revert to Comfort Off mode.
- **Setback Mode:** This is an additional feature available to timer mode, with this mode active the appliance will control the room to a pre-set temperature during timer 'off' periods.
- **Adaptive start Mode:** This is a predictive mode that functions alongside the timer mode. When activated it will automatic calculate when the appliance needs to switch on so that the desired room temperature has been achieved from the start of a heat on time period. If not active the appliance will only switch on at the programmed on time.
- **PIN Lock Mode:** This mode will lock the appliance in the existing mode and will only allow some basic functions to operate. Once activated, in order to change settings the user must input a pre-set PIN. This is ideal where it is desired to limit the use and functionality of the appliance.

## Home Screen

Typically the Home Screen will display the active operational mode, the desired room temperature set-point and the heating status. Any of the Advance function which are active will also be displayed on the home screen. Pressing **ENTER** while on the Home screen will display the current time..

*Target room temperature (set-point) display, this is not an actual room temperature display.*

*Product heating status display, this indicates when the appliance is actively heating or maintain a room temperature, 'ON' will be displayed. Otherwise, 'OFF' will be displayed*

*Active mode display, the active mode of operation is displayed at the bottom of the screen*

*Sleep mode, when the remote is left inactive, the remote display will sleep, turning the screen off. Briefly hold **ENTER** to wake the remote back up.*

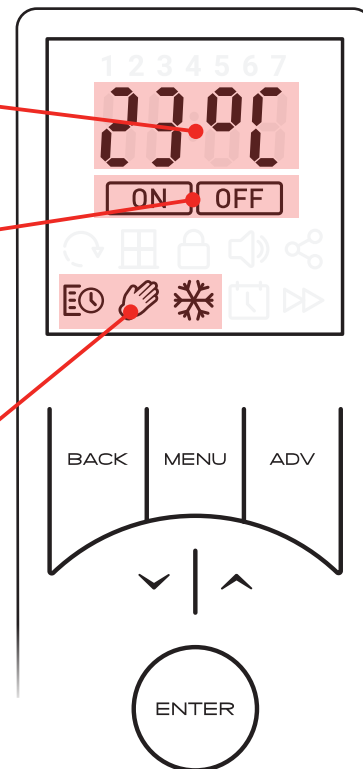

The remote control will enter sleep mode if left idle for the following intervals

- Home Screen – Sleep after 10 seconds
- Menu Screens – Sleep after 15 seconds
- Settings – Sleep after 30 seconds



**NOTE:**

When the remote wakes, it must search for and re-connect with the heater. This happens automatically and is indicated by the connectivity icon and the pairing graphic. Once pairing is complete the product will beep and the remote home screen is visible.

## Navigation and Selecting Modes

The remote control and menus are navigated using the six button keypad. In order to select/ change operational mode, press the **MENU** button. The remote will then enter the basic menu structure, this menu provides the option to quickly select the following options, each option is represented by an icon.

- **Timer Mode:** Activate mode or set/alter the program times and temperatures,
- **Manual Mode:** Activate manual heating mode,
- **Frost Protect:** Activate frost protection mode,
- **Time & Date:** change the time and date settings
- **OFF:** Activate Comfort off mode

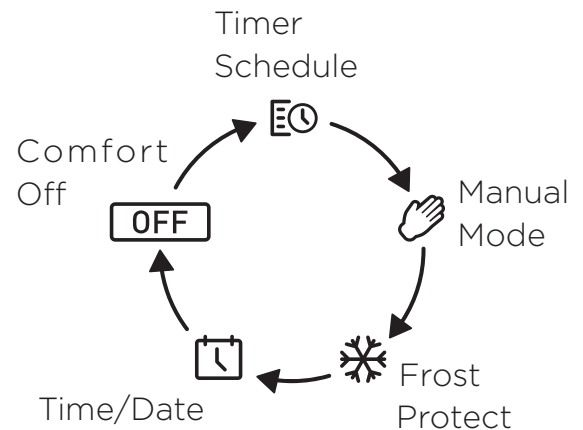

The primed mode for selection will be indicated by the flashing icon, use the **Arrow** keys to navigate to the desired icon and confirm selection using the **ENTER** key. Depending on the mode selected you may be prompted for further action, see relevant section relating to this mode.

## Thermostat Control

The heater is fitted with an adjustable electronic thermostat enabling the room temperature to be controlled in all the operational modes. The minimum controllable room temperature available is 7°C and the maximum temperature is 30°C.

A temperature of 21°C represents a normal 'Comfort' room temperature and this is set as default in manual mode. Frost protect has a default value of 7°C. Temperatures in Timer mode can be set to suit the application.

The temperature set point can be adjusted at any stage by using the Up & Down arrows when the home screen is active.

## Heat Output Selection

The remote control offers the facility to select the heat output from the appliance between **HI**, **LO** heat and FAN settings. **HI** heat is set by default. This is a global heat setting and once set all other operational modes will operate with this setting.

In order to set/change the heat setting:

- From the home screen press and hold the **ADV** button for 2 seconds. The remote will enter the heat selection screen.
- Use the arrow keys to navigate to the desired setting and confirm using the **ENTER** key. The **FAN** is on a separate screen that is accessed by continuously pressing the arrow keys.
- The remote will return to the home screen and all heating modes will function with the selected heat output.

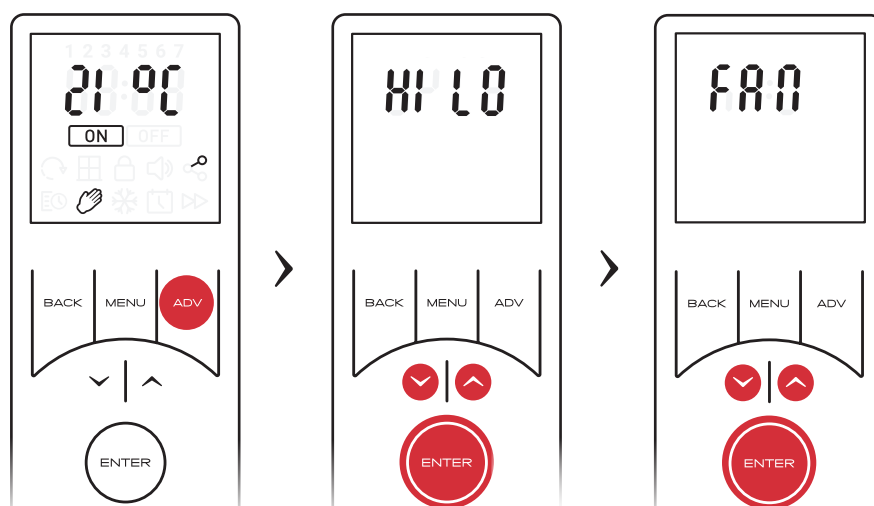

**NOTE:**

The HI temperature setting will modulate the heat output to optimise the efficiency of the product. As the room temperature approaches the set-point the heater will automatically switch to the lo heat setting.



**NOTE:**

If FAN output is selected, FAN will be visible on the home screen instead of time.

## Timer Mode

The Timer offers the most efficient mode of operation for a predictable heat demand. The user has the flexibility program up to four distinct time and temperature profiles per day, per week. The user has the ability to adjust the temperature during any heating period and additional functions such as 'Advance' and set back add to the flexibility and comfort of this heating mode.



**NOTE:**

*If Adaptive Start is enabled, the heater may operate outside the programmed heating period. This is normal and is required to ensure the adaptive start function operates correctly.*



**NOTE:**

*If Set back mode is enabled, the heater will not revert to off outside the programmed 'On' periods. The appliance will remain active and control to the pre-set setback temperature.*

### Activating the Timer

To activate the Timer mode:

- Press the **MENU** key from the home screen.
- Use the arrow keys to highlight the Schedule Icon,
- Press **ENTER** to enter Timer Settings.
- Ensure 'On' is highlighted and Press **ENTER** again to activate timer mode.

The active settings and target set temperature will be displayed on the home screen.

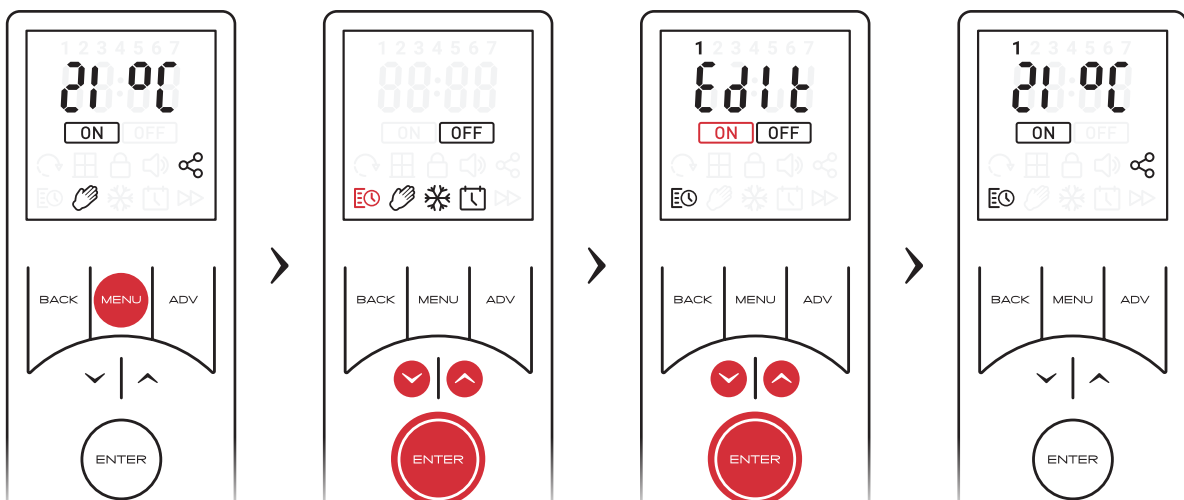

## Setting/Modifying the Time Profiles

- Press the **MENU** key from the home screen.
- Use the arrow keys to highlight the **Schedule Icon**,
- Press **ENTER** to enter Timer Settings.
- Use the arrow keys to highlight ' Edit' and Press **ENTER** again to confirm selection.
- Use the arrow keys to select the day of the week you wish to set and confirm using the **ENTER** key.

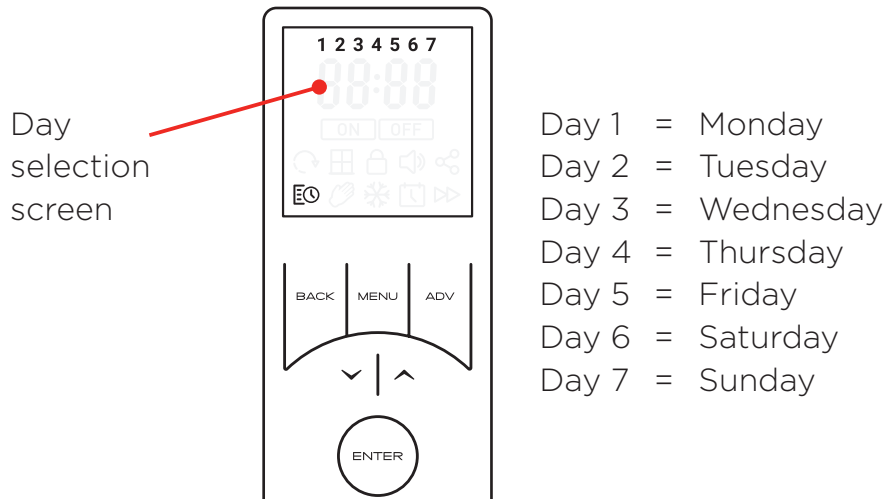

- Use the arrow keys to select the period (1-4) you wish to set and confirm using the **ENTER** key.
- Use the arrow keys to edit the 'On' time, confirm each digit using the **ENTER** key. After the final digit is confirmed the remote will automatically enter the set-point setting screen.
- Use the arrow keys to set the desired set-point temperature, confirm using the **ENTER** key.
- The 'Off' time should then be set using the same method as the 'On' period .

You will then be returned to the Period setting screen, with the next period highlighted. The previous Period has been successfully set and is confirmed by a beep from the appliance. The remainder of the periods can then be set as per the above procedure.

Alternatively the timer setting mode can be exited by pressing MENU or continuously pressing the BACK key



### NOTE:

*If the MENU key or the BACK key is used exit setting mode from the time or temperature setting screen the changes will not be saved, it is essential that the final 'Off' time is confirmed and a beep is heard from the appliance before exiting this mode.*

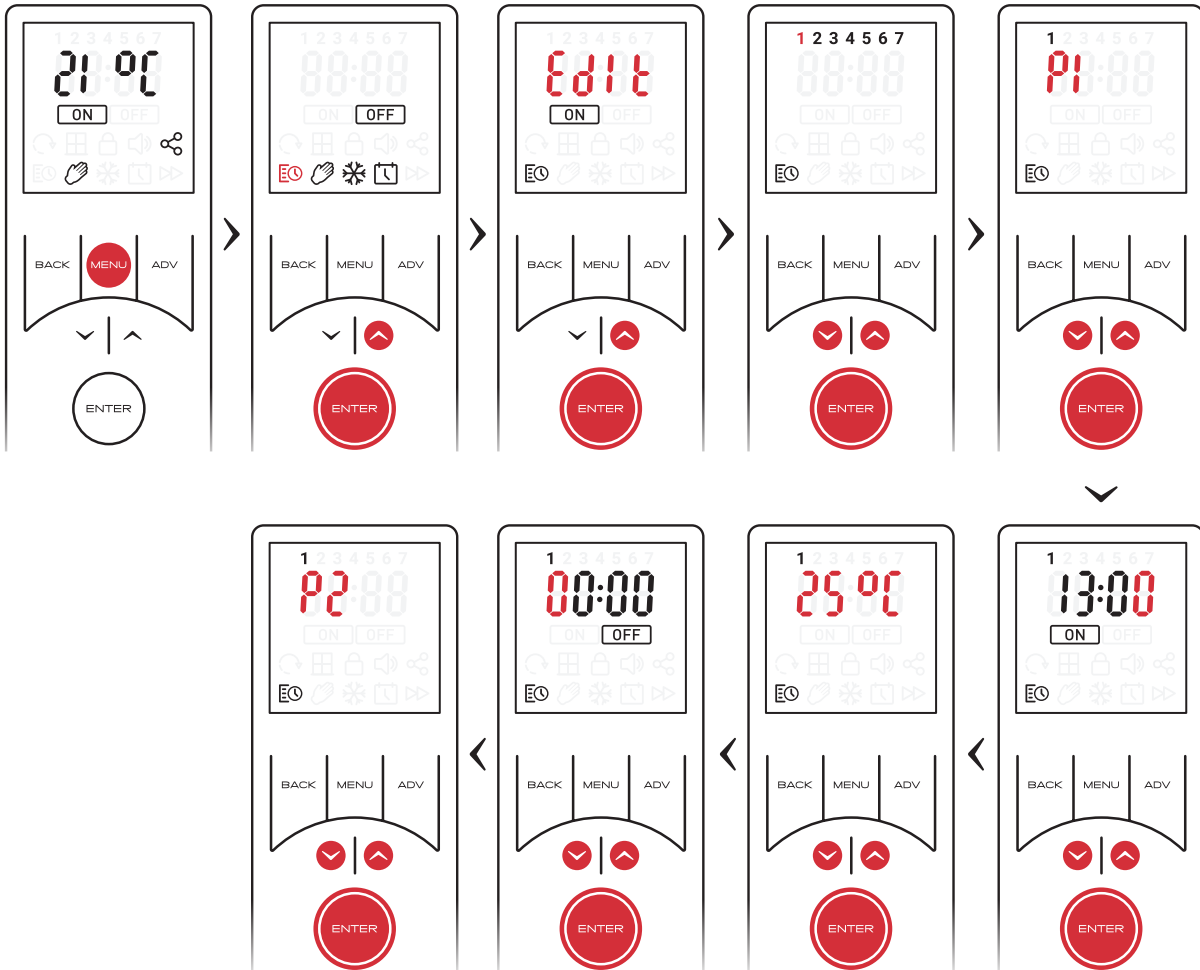

## Copy and Paste Time profiles

It is possible to copy the complete time profile from one day and paste it to another day. This will copy all four program periods and associated time and temperatures. To copy and paste a day profile:

- From the day selection screen, use the arrow keys to highlight the day you wish to copy.
- Hold the **ADV** key for 2 seconds, 'COPY' will flash on screen to show it has copied.
- Use the arrow key to highlight the day to which you wish to copy the profile.
- Hold the **ENTER** key for 2 seconds, 'PSTE' will flash on the screen and the appliance will beep to signify the timers have been pasted successfully.
- If required the same profile can then be copied to other days using the same 'Paste' procedure.

1. Hold **ADV** for 2 seconds on Monday (1)

2. Press **UP** until Thursday (4) is flashing

3. Hold **ENTER** to paste timers onto selected day

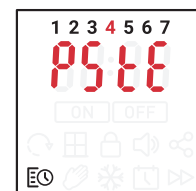
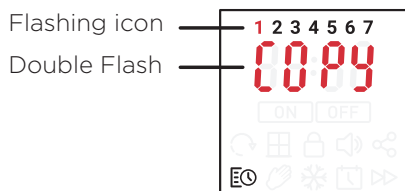

## Continuous Heat Modes

A Continuous Heat mode is effectively a constant heat control period. The heater will maintain a pre determined room temperature indefinitely irrespective of time until the mode is changed by the User.

### Available Continuous Heat Modes

Each continuous heat profile is preloaded with a default Target Temperature value but is fully adjustable.

- Manual mode
  - Default temperature 21°C
  - Can be changed from the Home Screen to any value within the Heater's Temperature Range.
- Frost Protection
  - Default 7°C
  - Can be changed from the Home Screen to any value, however once the temperature is changed the unit will revert to a standard Manual mode.
- Comfort Off
  - Heating OFF, no temperature control.

### Activating a Continuous Heat Mode

#### Manual Mode (Comfort On)

This mode ignores the User Timer and maintains the displayed temperature.

To activate Manual Mode:

- Press the **MENU** button,
- Use the arrow keys to highlight the Hand Icon, then press **ENTER** to confirm.
- Use the arrow keys to adjust the target temperature.

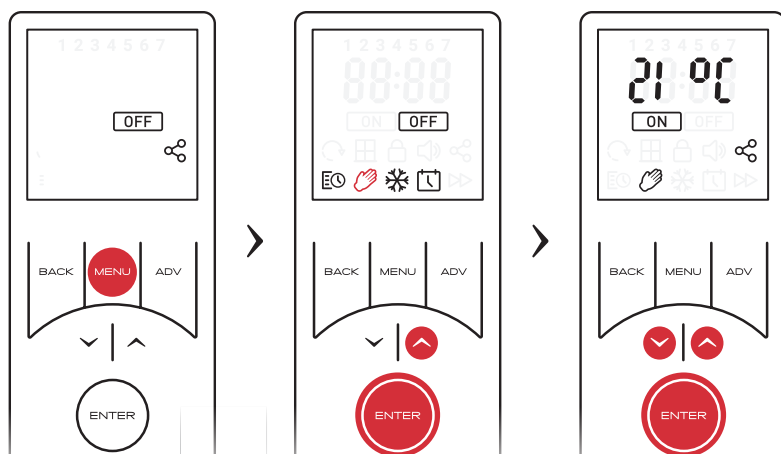

**NOTE:**  
If the temperature is set to 7°C, the mode will automatically change to Frost Protect



## Frost Protect

This mode maintains a constant room temperature of 7°C. This mode is not intended for human comfort and should be used to provide protection against frost. This mode is indicated by the Frost icon.

To activate Frost Protect mode:

- Press the **MENU** key from the home screen.
- Use the arrow keys to highlight the Frost Icon,
- Confirm the selection by pressing the **ENTER** key,
- The home screen will reconfigure to indicate Frost protection mode is active.
- Alternatively frost protection mode can be accessed direct from the manual mode by pressing the down arrow until the set-point reached 7°C.

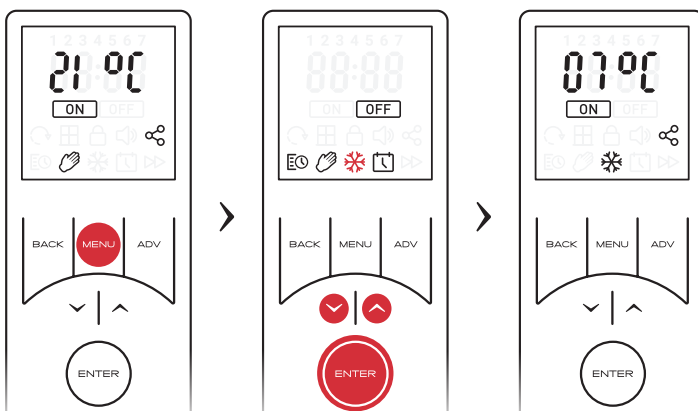

### NOTE:

*If the temperature is raised in Frost Protect, the product will automatically enter Manual Mode*

## Comfort Off

When activated, this appliance will provide no room temperature control. No active mode will be visible on the screen but the remote will display the current time and day indicating the appliance is in comfort off mode. The remote screen will still revert to sleep mode.

To activate Comfort Off mode:

- Press **MENU** from the home screen,
- Use the arrow keys to highlight the OFF icon,
- Press **ENTER** to confirm the selection,
- Alternatively, Comfort Off mode can be activated at any time if the **BACK** button is held for 2 seconds

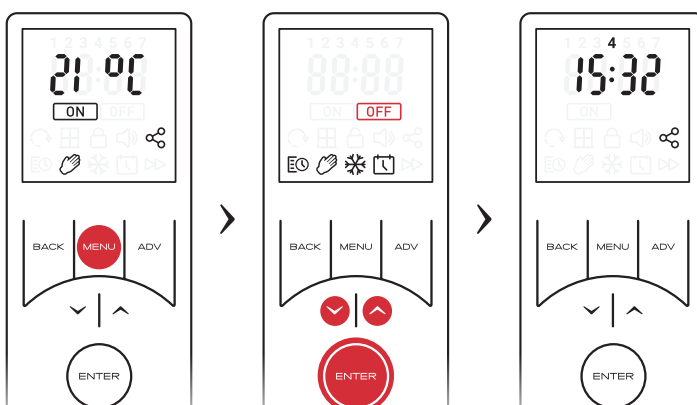

### Important:

*Comfort Off mode is an active state and does not imply the appliance is Off, it is simply not controlling to a room set point.*

## Advanced Mode Functions

These functions modify the normal behaviour of the appliances operational modes. The advanced functions available will depend on the active operation mode. For example, an advance function is only available when timer mode is operational, and similarly a runback function is only available for continuous heating modes.

### The 'Advance' Function

The **ADV** button forces the next timer segment to activate early, this forces a temporary change and will not effect the timer schedule. This allows the user the flexibility to begin or end a programmed heating period early, with the touch of a button.

This is useful if you are at home when you had not planned to be, or need to leave when you had planned to have the heating on.

If the remote displays **OFF**, Schedule Icon or no target temperature, and heat is required, press the **ADV** button. If the remote displays ON and heat is not required, press the **ADV** button and the heater will stop heating until the beginning of the next ON period.

Pre-action State	Action	Impact
Heating On (Timer Mode)	Advance activated	Heating On period switched to Heating Off until the next scheduled 'Comfort On' period.
Heating Off (Timer Mode)	Advance activated	Heating Off switched to Heating On until the next scheduled 'Heating Off' period.
Heating On (Advance Active)	Advance deactivated	Heating On switches to Heating Off. Appliance will follow schedule set in the currently active Timer Profile
Heating Off (Advance Active)	Advance deactivated	Heating Off Switches to Heating On. Appliance will follow schedule set in the currently active Timer Profile

## Runback

The Runback mode will assign a timed period to a continuous heating mode. Once this time period has elapsed the appliance will revert to Comfort Off mode. When runback has been activated and the **ADV** key is pressed from a continuous heating mode then it is possible to select between four available time durations. See Advanced Menu instructions on **page 28** for details on activating runback and setting the time periods.

### Initiating Runback

- While in a continuous heat mode, press the **ADV** button to initiate the runback function. The shortest available runback duration will appear flashing on the screen.
- If desired the additional runback duration periods can be accessed by pressing the **ADV** button. There will be four runback time durations available to select from.
- Continue pressing Advance until the desired runback time has been reached
- When satisfied with the selection press **ENTER** to confirm.
- Once active the set-point will change to the pre-set value that has been selected during the runback setup. The set point can be changed at any stage using the arrow keys.
- The display will then alternate every 2 seconds between runback time left and current temperature set point.

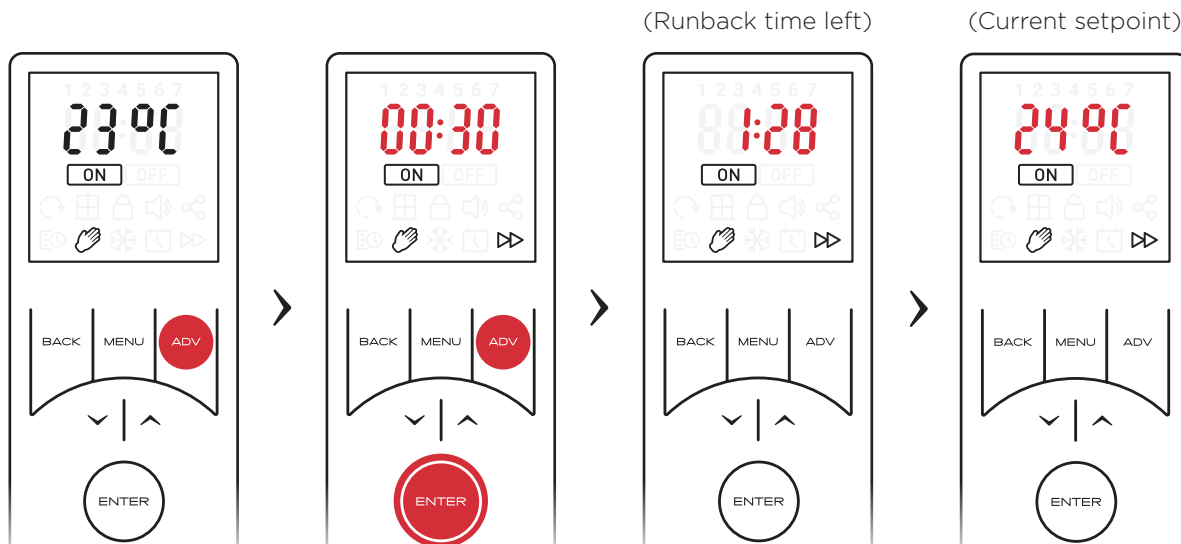

### Deactivating Runback

- During a runback period, use the **ADV** button to cycle through runback settings until 'OFF' is flashing.
- Press **ENTER** to confirm return to home screen in the heaters previous heat setting.

## Advanced Menu

The advanced menu contains several additional settings required for non standard applications and installation. It is from within this menu the runback function can be activated and the details can be setup. Setback, PIN lock and advanced start options are also controlled from this menu.

To access the Advanced Menu, hold down the **ADV** and **MENU** buttons for 2 seconds. You will then be able to scroll through the four advanced menu options by using the arrow keys. Press **ENTER** to confirm your selection.

The advanced menu options are:

- Runback
- Setback
- Adaptive Start
- PIN lock

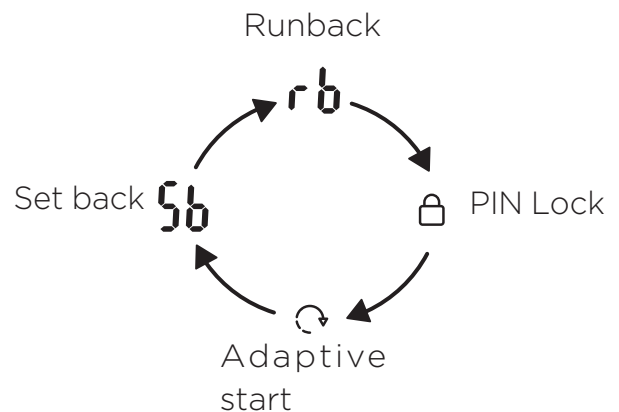

### Runback Settings

This menu is used to activate the runback function and also setup the main function parameters, see 'Runback' in 'Advanced mode Functions' for description of this mode.

To activate and setup Runback mode:

- Hold down **ADV** and **MENU** buttons for 2 seconds.
- 'rb' will be highlighted on the screen
- Press **ENTER** to enter the Runback settings
- Use the arrow keys to toggle Runback ON or OFF. Selecting OFF will return you to the home screen with Runback deactivated.
- If you require to activate runback then highlight the 'ON' icon and press **ENTER** to edit the Runback time

- You will be required to select a Maximum Runback Duration, this value can be selected from the pre programmed list. Each Max Duration will provide four selectable runback periods. See the table below for a break down of the options available:

Maximum Runback Duration	Selectable Runback options			
	Period 1	Period 2	Period 3	Period 4
0:30	0:15	0:20	0:25	0:30
1:00	0:15	0:30	0:45	1:00
1:30	0:15	0:30	1:00	1:30
2:00 (default)	0:30	1:00	1:30	2:00
4:00	1:00	2:00	3:00	4:00
6:00	1:30	3:00	4:30	6:00
8:00	2:00	4:00	6:00	8:00

- Use the arrow keys to select to the desired runback time. Press **ENTER** to confirm and move onto Runback temperature settings.
- Use the arrow keys to select the desired Runback temperature. Press **ENTER** to activate the Runback timer and return to the home screen.

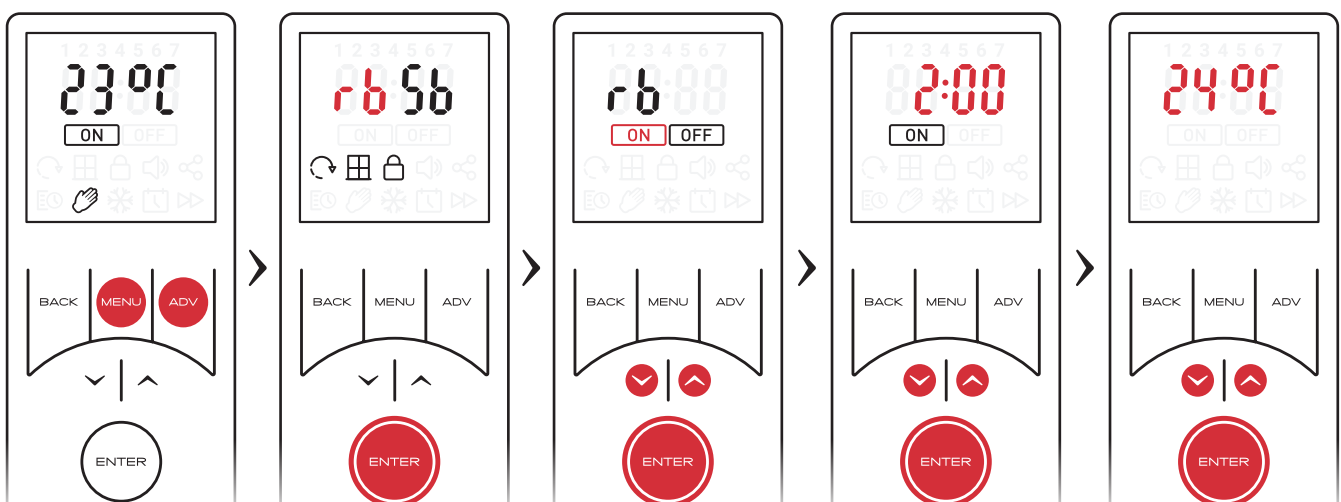

**NOTE:**

When activated the temperature set-point which has been set during the mode setup (above) will be active. This value can be adjusted temporarily during runback mode operation by using the arrow keys.

## Setback Settings

Setback is a function that only modifies Timer Mode operation. When Setback is enabled it overrides any **Heating Off** period to maintain a constant temperature during Heating Off periods.

This can be used to prevent the room temperature from falling below a minimum value while there is no demand for heat (**Heating On**).

To activate and setup setback mode:

- Hold the **ADV** and **MENU** buttons for 2 seconds.
- Use the arrow keys to highlight 'Sb' and confirm using the **ENTER** key
- Use the arrow keys to select Setback ON or OFF.
- Selecting OFF will return you to the home screen with Setback deactivated.
- If 'ON' icon is selected, you will be required to set a Setback temperature.
- Use the arrow keys to select the desired setback temperature. Press **ENTER** to confirm and return to the home screen. Setback mode will be active

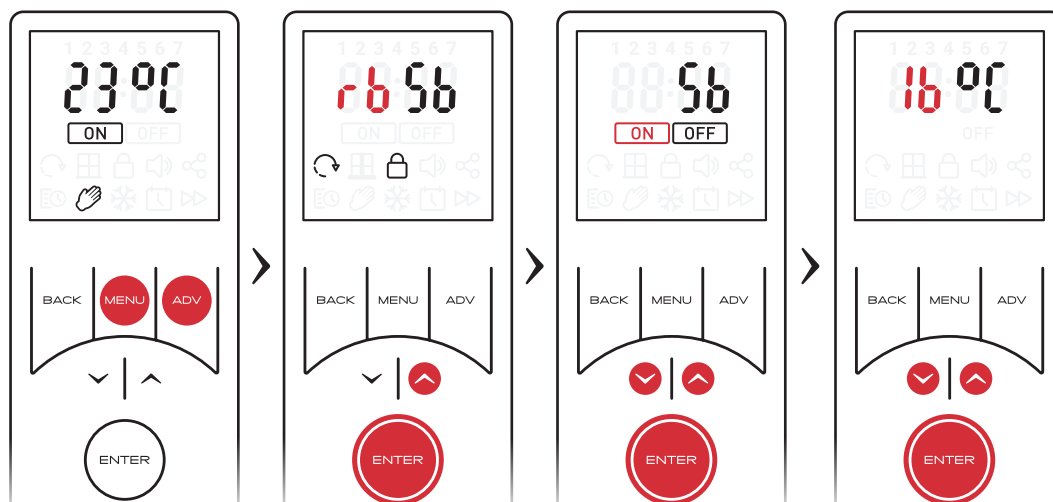

## Adaptive Start

Adaptive Start is a predictive function that only modifies Timer Mode operation. This function models the heating characteristics of the room and uses that information to pre-heat the room to ensure the target temperature has been reached by the start of the Heating On period.

For example, with Adaptive Start off, the **Heating On** time is the time that the Heater will begin to try and achieve the **Target Temperature**. With **Adaptive Start** On, the Heater will begin to heat the room before the User-defined **Heating On** time so that

the **Target Temperature** is achieved when the User defined the **Heating On** start time.

To activate Adaptive Start:

- Hold **ADV** and **MENU** buttons for 2 seconds
- Use the arrow keys to highlight the adaptive start icon and confirm using the **ENTER** key
- Use the arrow keys to toggle Adaptive Start ON or OFF
- Press **ENTER** to confirm your option and return to the home screen. If adaptive start has been activated, the icon will be visible when in timer mode home screen.

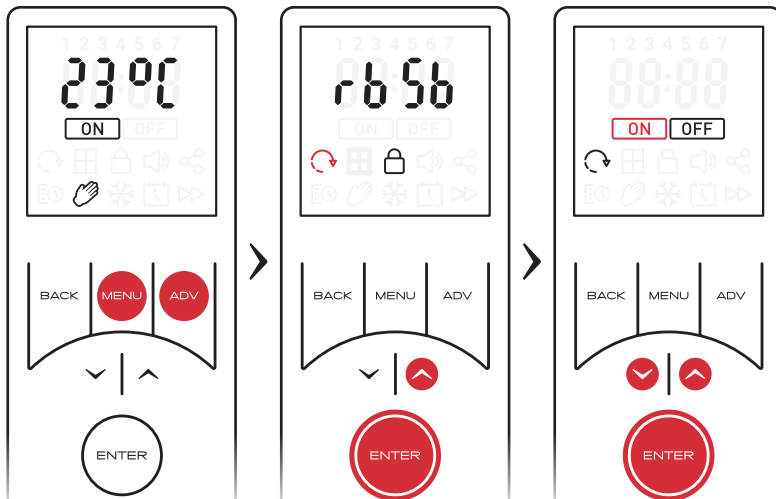

**NOTE:**

*This is a continuously learning function and will be affected daily by changes in the heater's environment. The heater will take into account the starting temperature of the room so pre-heating should remain accurate.*



**NOTE:**

*It is important that if multiple heaters are installed in one room that all heaters have the Adaptive Start (AS) function enabled. If this is not the case, heaters with AS enabled will pre-heat the room to the desired target temperature before the heaters with AS disabled attempt to output heat.*

*It is likely that if multiple heaters are required in one room, that the output from one heater may not be sufficient to heat the room alone. This may cause the pre-heat time calculation to extend to a large degree if the heaters do not all have AS enabled. This may lead to heat at unwanted times and excessive wear to some heaters.*

*A two-hour limit is enforced on the calculation, however, if all heaters have AS enabled and pre-heating takes over one-hour, extreme environmental factors may be affecting the calculation or the heaters may be under sized for the room. Please contact us for support if your pre-heat time seems excessive.*

## PIN Lock

This locking method utilises a PIN code that is set by the User. When activated, the appliance is locked in the previously active mode and user will be restricted to basic functions. In order to change the mode or settings the PIN code must be re entered.

It is important that all required parameters such as time profiles and/or temperatures are set and the desired mode is activated before applying the PIN lock.

The following table summarises the product function after PIN lock has been applied

Active mode	Function after PIN lock is applied
Timer mode	All functionality will be disabled, the appliance will continue to follow the pre-set time and temperature profiles. Advance function is not available
Comfort On	All functionality will be disabled, the appliance will continue to control to the pre-set comfort on temperature. Runback mode is not available
Frost protect	All functionality will be disabled, the appliance will continue to provide frost protection. Runback mode is not available
Comfort Off	All functionality will be disabled, the appliance will remain in Comfort off mode with no heat or temperature control. Runback mode (if active) can be initiated using the <b>ADV</b> key.

To activate PIN Lock:

- First ensure the appliance is in the desired mode of operation, continuous heat or user timer, ensure the desired temperature or time profiles are set and any desired advanced modes are enabled.
- Hold **ADV** and **MENU** buttons for 2 seconds
- Use the arrow keys to highlight the Pin Lock symbol and confirm using the **ENTER** key.
- Use the arrow keys to select the first digit. Press **ENTER** to set the next digit. Repeat until all four digits have been set. Press **ENTER** to return to the Home screen with the device PIN locked.

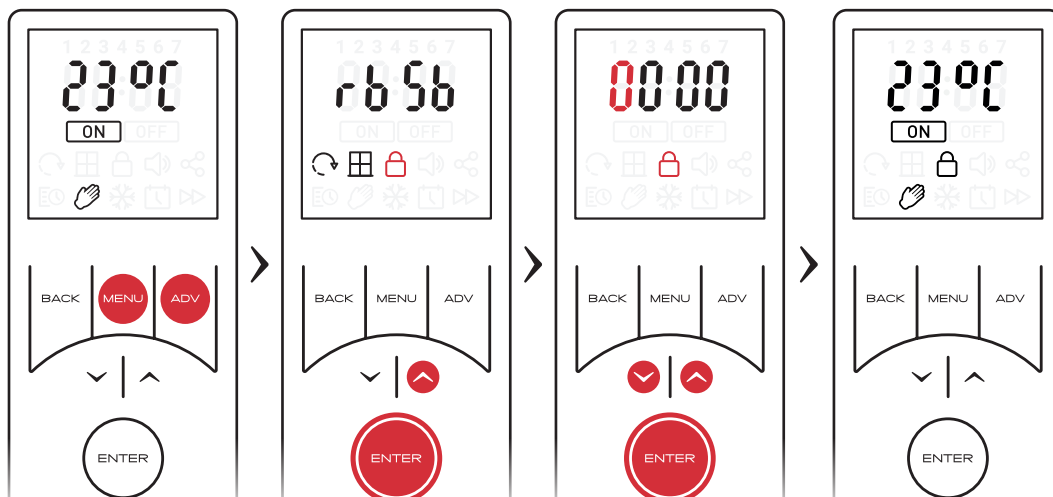





**NOTE:**

Once the PIN has been set you will be required to re-enter the PIN if any button is pressed. The only exception is when the criteria has been met to allow runback mode using the ADV key.

### Exiting PIN Lock mode

- Press any button to enter the PIN display
- Use the arrow keys to input the first digit. Press **ENTER** to confirm.
- Repeat until all four digits have been entered, then press **ENTER** to confirm.

If the correct PIN has been entered, the device will be unlocked and you will be returned to the home screen.

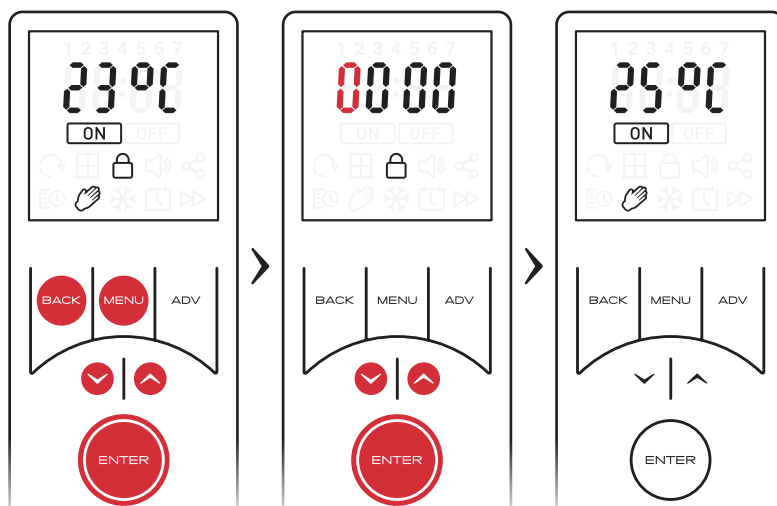

If incorrect, the word 'Inc' will flash for 1 second, 'Pin' will be displayed for 1 second, then the screen will return to the PIN locked home screen



Screen is displayed for 1 second before moving to next screen



Screen is displayed for 1 second before moving to next screen

# Service Settings

## Temperature Settings

To choose whether the remote displays degrees Celsius or degrees Fahrenheit:

- Hold down the **MENU** button for 2 seconds
- Use the arrow keys to toggle °C or °F.  
The highlighted option will be flashing.
- Press **ENTER** to confirm your selection and return to the home screen

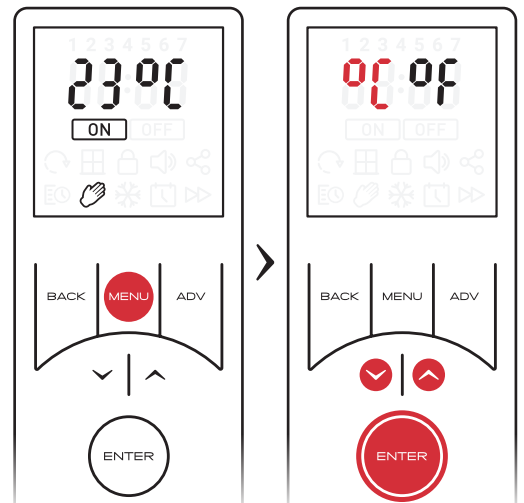

## Appliance ID & Software versions

The appliance and remote control are preloaded with software to ensure correct operation. In some cases it may be necessary to reference the software version that is installed on the remote or appliance. Both software versions along with the unique Bluetooth appliance ID can be viewed using the remote control

To view the information:

- Hold down **ENTER** for 2 seconds
- Use the arrow keys or the **ENTER** to scroll through the information pages
- Once all the information screens have been viewed, the remote will return to the home screen.

Alternatively if idol for 5 seconds the screen will return to the home screen. You may exit this screen at any time by pressing **BACK**.

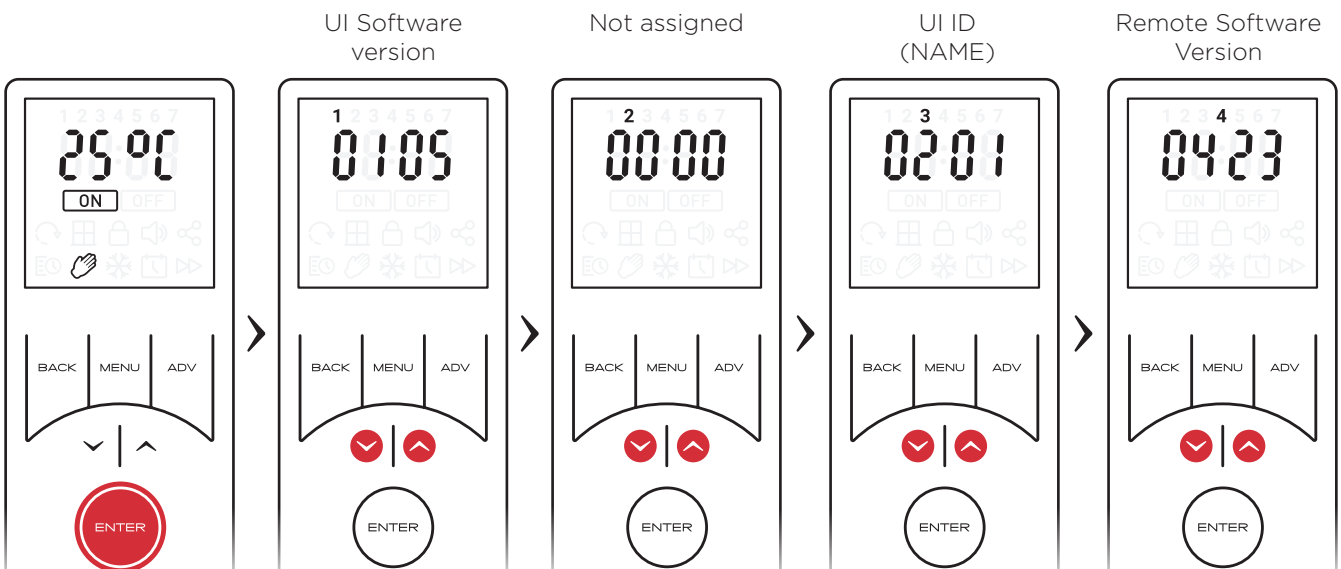

## Factory Reset

If you wish to either reset the heater to default values, or disconnect and restore default values of the Bluetooth remote:

- Hold down **Up** and **Down** buttons at the same time for 5 seconds to enter “Fr” (Factory Reset) options.
- Use the arrow keys to toggle factory reset Heater (h) or Remote (r) and press **ENTER** to confirm your option
- Use the arrow keys to toggle Factory reset YES (y) or NO (n), and press **ENTER** to confirm your option.

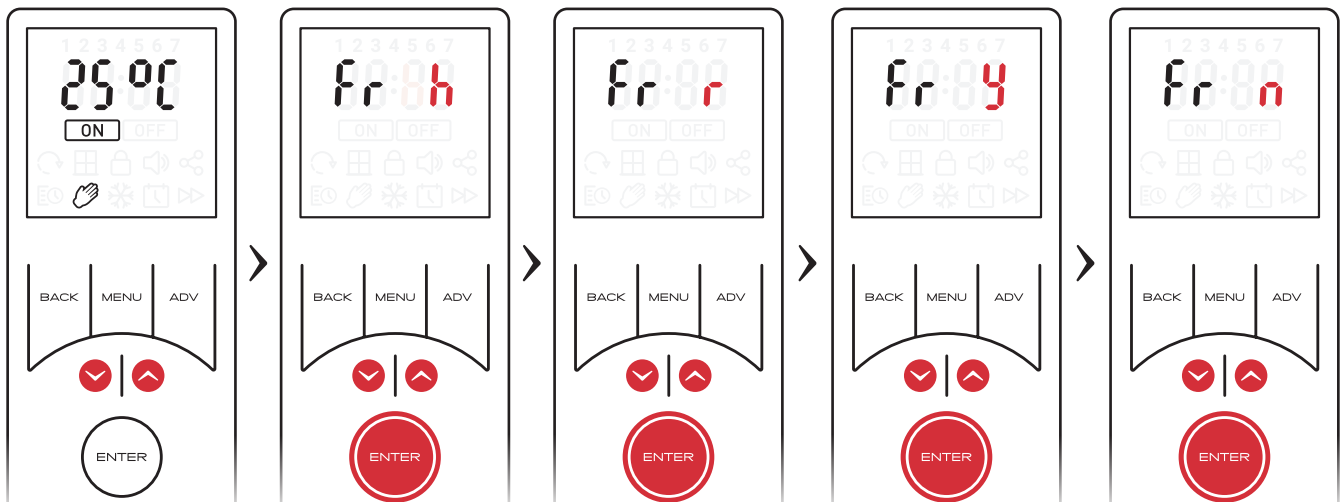

## Error Codes

If an error code (Er 20) appears flashing on the remote screen, this indicates that there has been an issue with the room temperature sensor. Please contact customer service. .

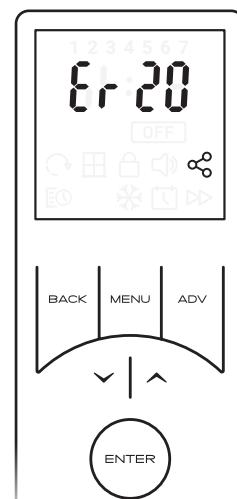

## Maintenance

### Battery Replacement

#### IMPORTANT

Battery should be disposed of in an appropriate manner

See **page 11** for battery fitting instructions.



#### NOTE:

*Whenever new batteries are fitted or replaced the Bluetooth remote control will automatically reconnect with the product. However, the time and date settings on the handset will have been lost and must be reset for time profiles to function correctly*

### Cleaning

**WARNING - ALWAYS DISCONNECT FROM THE POWER SUPPLY BEFORE CLEANING THE HEATER.**

### General Cleaning

Before commencing cleaning, isolate the heater from the electrical supply and allow it to cool. External appearance can be maintained by wiping occasionally with a damp cloth; for stain removal, a weak soap solution can be applied, then wipe dry. Care must be taken to avoid any moisture ingress into the product.

## Important



For electrical products sold within the European Community. At the end of the electrical products useful life it should not be disposed of with household waste. Please recycle where facilities exist. Check with a Local Authority or retailer for recycling advice in your country. Batteries should be disposed of or recycled in accordance with WEEE Directive 2012/19/EU. Packaging should be recycled where possible.

## What does a Dimplex Warranty cover?

Dimplex products deliver reliable service for normal, household use in domestic settings. All Dimplex products are individually tested before leaving the factory.

If you are a consumer and you experience a problem with your Dimplex product, which is found to be defective due to faulty materials or workmanship within the Warranty Period, this Dimplex Warranty will cover repair or - at the discretion of Dimplex - replacement with a functionally equivalent Dimplex product.

The Dimplex Warranty Period is two calendar years from the date of purchase of your Dimplex product, or the date of delivery of the product, if later. The Dimplex Warranty is conditional upon you providing the original purchase receipt as proof of purchase. Please therefore retain your receipt as proof of purchase.

If you do experience a problem with your Dimplex product please call the Helpline on **+44 (0)344 879 3588** or visit **<https://www.dimplex.co.uk/support>**. For ROI please email **[serviceireland@glendimplex.com](mailto:serviceireland@glendimplex.com)** or call **+353(0)1 842 833**. We will need details of your Dimplex product, its serial number and a description of the fault which has occurred. You can find the model number and serial number for your Dimplex product on the heaters side. Once we receive your information and proof of purchase we will contact you to make the necessary arrangements.

If your Dimplex product is not covered by this Dimplex Warranty there may be a charge to repair your product. However, we will contact you for agreement to any charges before any chargeable service is carried out.

## What is not covered by a Dimplex Warranty?

The Dimplex Warranty does not cover any of the following:

- Any fault or damage to your Dimplex product due to faulty materials or workmanship occurring outside the two-year Warranty Period.
- Any fault or damage occurring to any pre-owned Dimplex product or to any other equipment or property.
- Accidental damage to your Dimplex product or damage to your Dimplex product from external sources (for example, transit, weather, electrical outages or power surges).
- Fault or damage to your Dimplex product which is:
  - Not due to faulty materials or workmanship or which is due to circumstances outside Dimplex's control.
  - Caused by use of your Dimplex product for anything other than normal domestic household purposes in the country where it was purchased.

- Caused by any misuse, abuse or negligent use of the Dimplex product, including but not limited to any failure to use it in accordance with the Operating Instructions supplied with the product.
- Caused by any failure to assemble, install clean and maintain your Dimplex product in accordance with the Operating Instructions supplied with the product unless this was carried out by Dimplex or its authorised dealers.
- Caused by repairs or alterations to your Dimplex product not carried out by Dimplex service personnel or its authorised dealer(s).
- Caused by use of any consumables or spare parts for your Dimplex product which are not Dimplex -specified.

### **Terms and Conditions**

- The Dimplex Warranty is valid for Dimplex from the date of purchase of your Dimplex product from a recognised retailer in the country of purchase and use, or the date of delivery of the product if later, always provided the original receipt has been retained and is produced as proof of purchase.
- You must provide to Dimplex or its authorised agents on request the original receipt as proof of purchase and - if required by Dimplex - proof of delivery. If you are unable to provide this documentation, you will be required to pay for any repair work required.
- Any repair work under the Dimplex Warranty will be carried out by Dimplex or its authorised dealer(s) and any parts that are replaced will become the property of Dimplex. Any repairs performed under the Dimplex Warranty will not extend the Warranty Period.
- Any replacement of your Dimplex product by Dimplex during the Warranty Period will start the two-year Warranty Period afresh from the date of delivery of the replacement Dimplex product to you.
- The Dimplex Warranty does not entitle you to recovery of any indirect or consequential loss or damage including but not limited to loss or damage to any other property.
- The Dimplex Warranty is in addition to your statutory rights as a consumer and your statutory rights are not affected by this Dimplex Warranty.

### **Contact Dimplex**

If you have any questions about what the Dimplex Warranty covers and does not cover or how to claim under the Dimplex Warranty, please contact us using the information on the back page.

### **Contact details**

Millbrook House, Grange Drive, Hedge End, Southampton, SO30 2DF



**Customer Helpline:** 0344 879 3588  
aftersales@dimplex.co.uk  
www.dimplex.co.uk

Glen Dimplex Heating and Ventilation  
Millbrook House, Grange Drive, Hedge End, Southampton, SO30 2DF