

METALCLAD

Deta Metalclad has a striking appearance with frontplates that fit flush to the back box, gently curving rockers and discrete neon indicators.

Metalclad is designed to withstand everyday knocks and scrapes. The durable and tough finish is further enhanced by a superb protective coating to stand up to arduous duty in virtually any environment.

It is ideal for use in all commercial and light industrial applications such as workshops, factories, warehouses, laboratories and hospitals as well as domestic applications in lofts and garages.

Products in the **Metalclad** range are guaranteed for 25 years.



PRODUCT FEATURES

DETA Metalclad products are packaged with the installer in mind. Each product is supplied with the frontplate in its own packaging, allowing the product to remain undamaged until required at second fix.

Installation could not be simpler with funnel entry colour coded terminals and clear white markings. Earth terminals have been increased in size for extra capacity and the earth bar is recessed for additional safety.

20mm knockouts are provided on all sides and the rear of the back box and are flush to give a clean appearance. Product also available with mounting boxes without knockouts.

Every Product is supplied with its own Back Box, except the Blank and Data Plates.

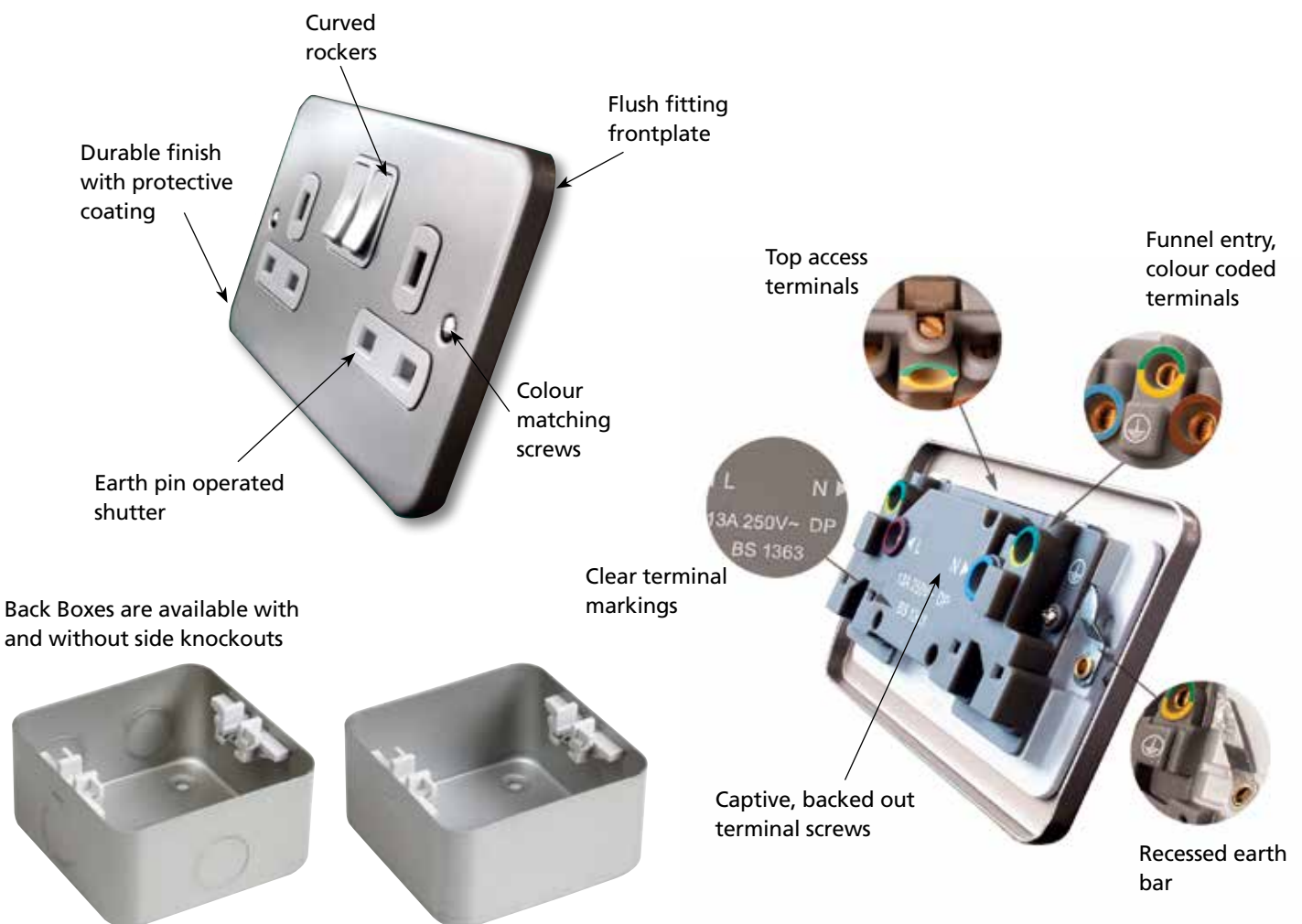

METALCLAD