

■ **SBDN – universal conduit take-off plates**

Mount to the base or side of steel wire cable tray to accept 20 mm or 25 mm diameter conduits. Use with 50 mm to 600 mm wide steel wire cable tray in 30 mm to 150 mm depths  
Supplied singly without fasteners

■ **Installation and assembly**

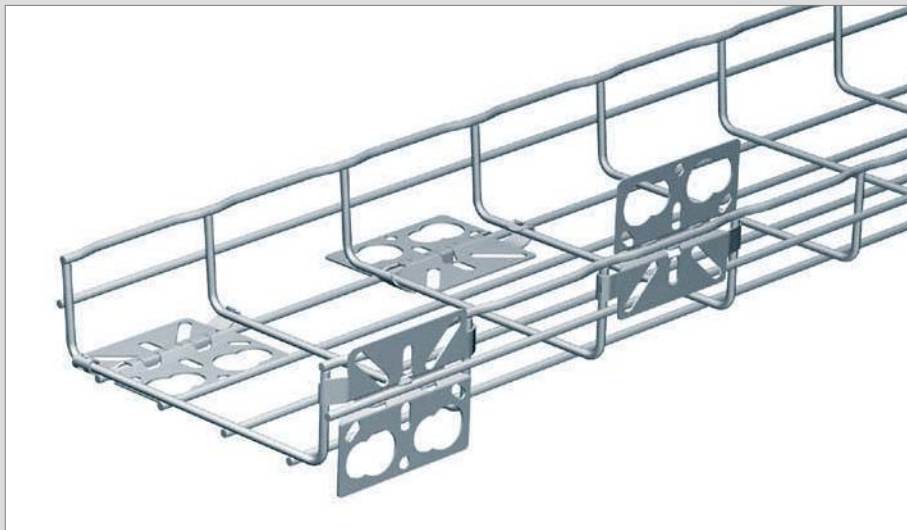

Fixing without nuts and bolts

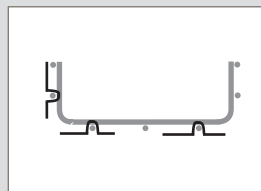

Position SBDN using the groove and bend tabs to secure

■ **Dimensions and weights**

↓ 30 → 150 mm ← 50 → 600 mm

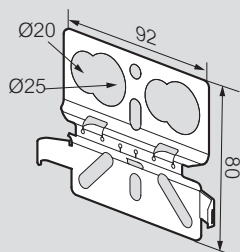

	Weight (kg)	
	GS	ZM
<b>SBDN</b>	0.2	0.2

Please use Cat. No. when placing your order, see p. 38

All weights are given in Kilograms (kg)

**Key:** GS Pre-galvanised  
ZM Zinc magnesium

For detailed information related to finishes, refer to **p. 132-133**

All dimensions (mm) are nominal