

# CHANNEL

SAFETY SYSTEMS

# Dale



## LED emergency exit signage from Channel Safety Systems

### CHANNEL SAFETY SYSTEMS

Petersfield Business Park  
Bedford Road  
Petersfield  
Hampshire  
GU32 3QA

t: 0845 884 7000

f: 0845 884 6000

e: [sales@channelsafety.co.uk](mailto:sales@channelsafety.co.uk)

w: [www.channelsafety.co.uk](http://www.channelsafety.co.uk)

INSTRUCTION MANUAL

# INSTALLATION

## All Installations should be carried out by a competent electrician.

1. Remove the diffuser from the body by removing the two fixing screws on the ends.
2. Fix base to wall or ceiling either direct or via conduit box, having cleared an access hole in the body for the cable.
3. ISOLATE THE A.C. SUPPLY and connect unit. An unswitched 230V A.C.±10% supply must be connected to the live (L), Earth and neutral (N) terminals near the PCB block.
4. The battery is pre-connected.
5. Refit Diffuser using the two screws.
6. Operational Check — Restore the A.C. Supply for 30 minutes and then remove. The LEDs should illuminate for at least 10 seconds.
7. Restore the A.C. supply and check that the indicator LED is 'on'.

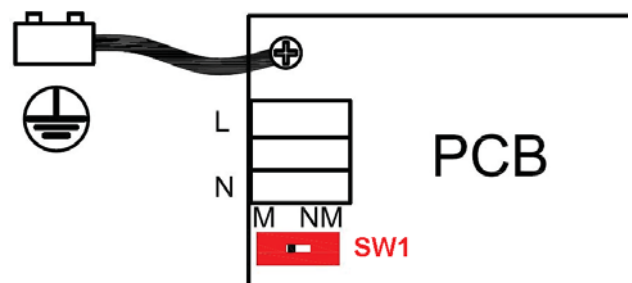
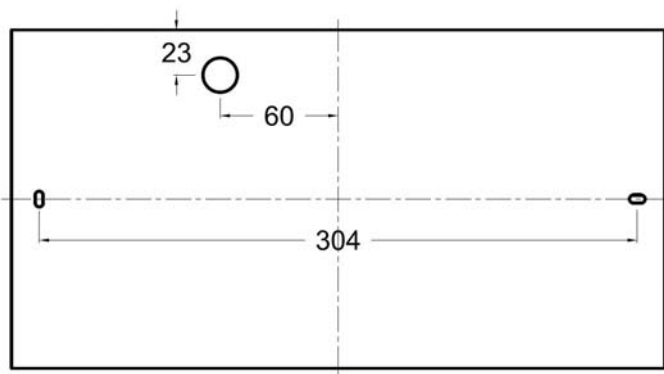

# OPERATION

## Non-Maintained

Emergency LEDs normally off, when switch SW1 is set to NM. The battery is on automatic charge (LED 'on'). LED strip will illuminate if A.C. supply is interrupted.

## Maintained

Emergency LEDs normally on, when switch SW1 is set to M. The battery is on automatic charge (LED 'on'). LED Strip will remain on if A.C. supply is interrupted.

## Monitoring

Green indicator lamp (LED) normally continuously 'on'. Indicator lamp goes out if A.C. Supply or charger fails.

## Battery

Sealed NiMH, 2.4V 1800mAH rechargeable battery pack.

## Temperature

Performance figures measured at 25 degrees C.

## Recommended Routine Test Procedure

This fitting incorporates an automatic self test function which meets the requirements, however please ensure Once each Day there is a visual inspection of battery charge led.

## Fault Finding And Corrective Action

### Monitoring Led Not Illuminated

A.C. Supply not healthy. Battery not connected. Charger failed.

### Unit Not Meeting Required Emergency Period

May need cycling: Discharge then recharge for 24 hours. Re-test, Battery pack may need replacing if emergency duration still not met.

## Environmental Parameters

Rated performance limits: Temperature Min 5PC Max 25°C

Humidity 80% max



**CAUTION: Work on the 230V mains circuit to be carried out by authorized electricians only, observing national installation regulations. Switch off the mains supply. before installing the product.**



**PLEASE NOTE: Write installation date on the battery's label. The light is supplied with discharged battery and must be connected to the mains for at least 20 h so that the battery can be charged to its working capacity.**

# TESTING

## Recommended Routine Test Procedure

The following test is designed to ensure the continued protection of your premises and occupants. Because of the possibility of a failure of the normal lighting supply occurring shortly after a period of testing, all tests should, whenever possible, be undertaken at times of least risk, e.g. during daylight hours.

### Once A Day

Visual inspection of battery charge led.

### Once A Month

Each unit should be energised from it's battery for adequate time to ensure, by simulation of a failure of the normal lighting supply, the emergency mode is functioning correctly.

### Once Each Year

All units should be placed into emergency mode and checked that the duration provided by the battery meets the specified time period.







### Dale Self-Test'

- 20 hours after applying mains voltage a function test is automatically run (30 sec. The items checked are 'emergency changeover and lamp.
- After a further 4 hours, an automatic 3 hour duration test is run. (If the test button is pressed for 5 sec. before the duration test has ended, the test is aborted.)
- Following the first duration test, regardless of whether or not this was passed, the weekly function test and yearly duration test are automatically started.

## Manual Operation

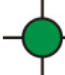
TEST BUTTON	GREEN LED	STATUS
Press for about 1 second	OFF	Emergency mode for 1 second
Press for about 3 seconds	Blinking (1 Hz)	Functional test for 30 seconds
Press for about 5 seconds	Flashing (3 Hz)	Duration test
Press again for about 5 seconds	Functional	Interruption of duration test

## Meaning of the indicator LED

Green	Red
 Mains operation No fault	 Duration test failed
 Blinking Functional test	 Blinking Lamp / changeover fault
 Flashing Duration test	 Flashing Battery / charging fault
 Mains failure + Emergency light operation	

The status display can only be cleared after the fault has been rectified, mains voltage has been reapplied and a function test has been run.

## Changing The Rechargeable Battery

If the emergency duration is less than 180 min., the rechargeable battery has to be replaced. Use only original batteries from the manufacturer.

**CHANNEL SAFETY SYSTEMS**

Petersfield Business Park  
Bedford Road  
Petersfield  
Hampshire  
GU32 3QA

t: 0845 884 7000

f: 0845 884 6000

e: [sales@channelsafety.co.uk](mailto:sales@channelsafety.co.uk)

w: [www.channelsafety.co.uk](http://www.channelsafety.co.uk)