

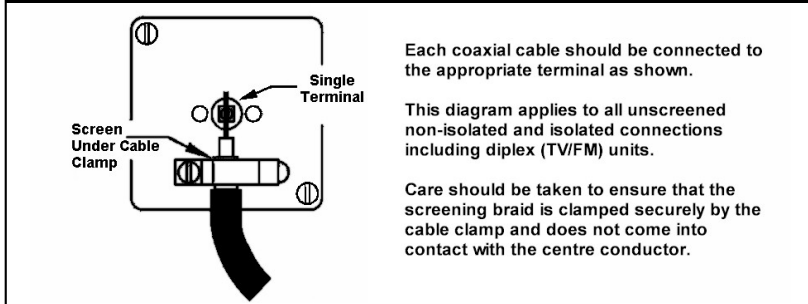

Order Code :  
94 TVI B  
Cheriton Victorian Satin Brass 1 gang  
Isolated Television. Standard Insert will be  
Black.

**Attributes**

|                               |                                      |
|-------------------------------|--------------------------------------|
| Primary Range                 | Cheriton Victorian                   |
| Insrt                         | TVI                                  |
| Plate material                | Metal                                |
| Size (single) height          | 88mm                                 |
| Size (single) width           | 88mm                                 |
| Size (single) depth           | 8.5mm                                |
| Box fixing hole centres       | 60.3mm                               |
| Minimum wall box depth        | 25mm                                 |
| IP rating                     | IP2XD                                |
| Earth Terminal Capacity 1     | 5 x 1mm <sup>2</sup>                 |
| Earth Terminal Capacity 2     | 4 x 1.5mm <sup>2</sup>               |
| Earth Terminal Capacity 3     | 3 x 2.5mm <sup>2</sup>               |
| Earth Terminal Capacity 4     | 1 x 4mm <sup>2</sup> Multi-Strand    |
| Earth Terminal Capacity 5     | 1 x 6mm <sup>2</sup>                 |
| Product Class 1               | Must be earthed (ref BS7671 415.2.1) |
| Ambient Operating Temperature | -5Â° to +40Â°C                       |
| Recommended Location          | Indoor use only                      |
| Max installation Altitude     | 2000m                                |
| Patents And Trademarks        | Trade Mark No. 2344779               |



|  |  |   |
|--|--|---|
| All products listed conform to current British or European standards and the product information is correct at the time of going to press. | All accessories are manufactured under an accredited BS EN ISO 9001 : 2008 Quality System.                 | It is the policy of the company to continually improve products as part of our development programme. Therefore, we reserve the right to alter designs and dimensions without prior notice. |
| Illustrations and diagrams are reproduced within the limitations of reproductions and printing processes are not binding.                  | Due to manufacturing processes we cannot guarantee an exact colour match and shadings of certain finishes. |   |

R. Hamilton & Co Ltd.      Unit G      Quarry Industrial Estate      MERE, Wiltshire      UK BA12 6LA  
Tel: +44 (0)1747 860088      Fax: +44 (0)1747 861032      Email: info@hamilton-litestat.com      Web: www.hamilton-litestat.com