

# LED LuminAir Fan & Light Ventilation Kit

- Unique fan and light combination
- IPX7 rated inlet assembly
- Suitable for shower enclosures and wet areas - can be used within reach of a person using a bath or shower
- Safety extra low voltage (SELV) fan and lamp
- Easy installation
- White and Chrome bezels available
- LED Lamp



## SELV Fan & Light Combination

LuminAir is also available in the form of a ventilation kit which, in addition to the fan and light combination, comes with a 90° bend, 3M of flexible ducting, wall grille and cable ties. The IPX7 unit is installed directly over a shower in complete safety.

Vent-Axia LuminAir extracts moisture and humidity at source, preventing damaging condensation from spreading. At the same time it bathes the shower enclosure in a rich soft light - bringing any dark shower to life. Ideal for all types of bathroom and shower applications, and is particularly suitable for bedsit and en-suite shower installations. LuminAir has a LED MR16 3W DC 12V lamp, to give a pool of soft warm light. The lamp has a long life and is simple to change.

Separate LED Driver also supplied, Input: AC100-240V, 50/60Hz, Output: DC12V 500mA, LED Power - 3-5W.

## Models

LuminAir L, T or H SELV fan and light, choice of bezel, 90° bend, 3m of flex-duct, wall grille and cable ties.

### LuminAir Shower Ventilation Kit L (Switch Live)

Provides simultaneous fan and light operation from the bathroom light switch.

Stock Ref

453410 (White)

### LuminAir Shower Ventilation Kit T (Timer)

Switches the fan On with the light. When the light is switched Off, the fan continues to run for an adjustable set period.

Stock Ref

453413 (White)

### LuminAir Shower Ventilation Kit H (Humidistat)

Combines a light activated by the bathroom light switch and an Ecotronic Humidistat Sensor which will switch the fan On whenever the humidity level warrants.

Stock Ref

453416 (White)

## Accessories

Optional Bezels

Stock Ref

452044 (Chrome)

## Installation Example

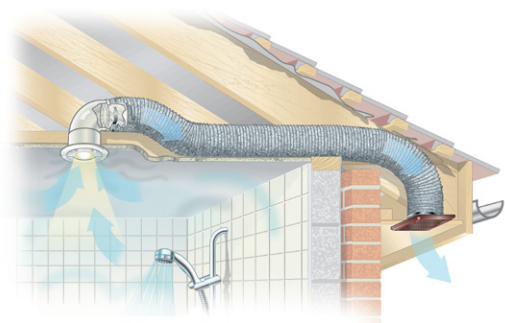

## Dimensions (mm)

### Vent Light

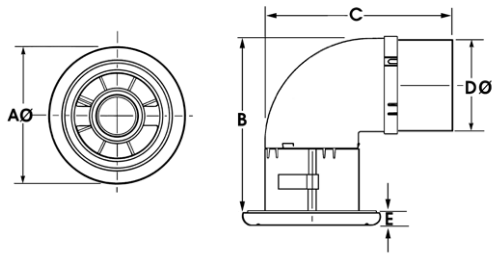

### Humidity Sensor

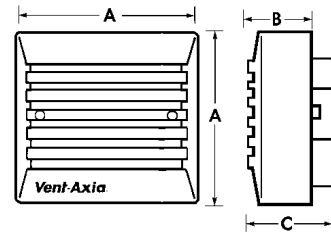

| Model           | AØ  | B   | C   | DØ | E  |
|-----------------|-----|-----|-----|----|----|
| Vent Light      | 150 | 180 | 139 | 98 | 10 |
| Humidity Sensor | 87  | 33  | 47  |    |    |

Fixing hole diameter 110mm

## Performance

| Model                          | Extract Performance - FID |     | Watts |      | Sound dB(A)<br>@ 3m | Amps<br>@ 240V |
|--------------------------------|---------------------------|-----|-------|------|---------------------|----------------|
|                                | m <sup>3</sup> /h         | l/s | Fan   | Lamp |                     |                |
| LuminAir Ventilation Kit L/T/H | 110                       | 31  | 20    | 3    | 35                  | 0.2            |