

Steel Conduit Tube, Accessories & Consumables

Steel & Brass

We offer the full range of steel & brass fixings for use with steel conduit tube, all manufactured in accordance with BSEN61386-1:2008+A1:2019 & BS 31 where applicable

Male Brass Bushes: Short

Size	Code	Pack
16mm	MBBS16	100
20mm	MBBS1	100
25mm	MBBS2	100
32mm	MBBS3	50
1.5"	MBBS4	50
2"	MBBS5	25

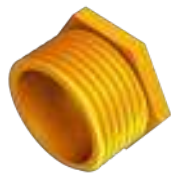

Brass Lock Rings

Size	Code	Pack
63mm	LR6	1
2.5"	LR7	1
75mm	LR8	1
3"	LR9	1



All brass lock rings are manufactured with a milled edge

Male Brass Bushes: Long

Size	Code	Pack
20mm	MBBL1	100
25mm	MBBL2	100
32mm	MBBL3	50
1.5"	MBBL4	20
2"	MBBL5	10
63mm	MBBL6	1
2.5"	MBBL7	1
75mm	MBBL8	1
3"	MBBL9	1



Box Lid Screws

Size	Code	Pack
M4 x 6mm	BM6	100
M4 x 10mm	BM10	100
M4 x 12mm	BM12	100
M4 x 16mm	BM16	100
M4 x 20mm	BM20	100
M4 x 25mm	BM25	100
M4 x 30mm	BM30	100
M4 x 35mm	BM35	100
M4 x 40mm	BM40	100
M4 x 50mm	BM50	100



All box lid screws are pan head

Female Brass Bushes

Size	Code	Pack
20mm	FBB1	100
25mm	FBB2	100
32mm	FBB3	100
1.5"	FBB4	100
2"	FBB5	25
63mm	FBB6	1
2.5"	FBB7	1
75mm	FBB8	1
3"	FBB9	1



Brass Slotted Plugs

Size	Code	Pack
20mm	BSP1	100
25mm	BSP2	100

