

**Product Description:**

The EFD™ PRO is our new range of stylish and professional fire rated GU10 downlights. Perfect for use with Enlite's market leading range of ICE™ lamps, the EFD™ PRO range is also fitted with our latest push-fit terminal block for even faster installation. The cast aluminium bezels for fixed, adjustable and IP65 rated options are available in four colour finishes to cover all applications.

**Product Image:**



**Product Features:**

- New and improved push-fit terminal block with loop in/loop out for quick and easy installation
- One piece slim interchangeable twist & lock bezels available in white, matt white, polished chrome and satin nickel (sold separately)
- Fibre based insulation coverable up to 300mm (LED lamps only)
- For a fixed version use EN-DLM981X & EN-BZ91
- For Adjustable use EN-DLM982X & EN-BZ92
- For IP65 rated use EN-DLM981X & EN-BZ93
- Tested in 30, 60 and 90-minute fire rated ceilings
- 5 year warranty

EFD™ PRO Adjustable Professional Fire Rated Downlight

**Line Drawing Image**

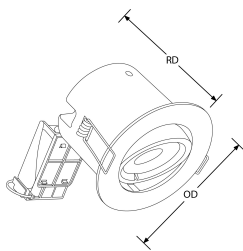

**Product Specs:**

<b>Luminaire Distribution</b>	Direct	<b>Input Voltage</b>	220~240V AC
<b>Input Frequency</b>	50/60HZ	<b>Dimmable</b>	No
<b>IP Rating</b>	IP20	<b>Fire Protection</b>	Yes
<b>Acoustic Rated</b>	Yes	<b>Overall Diameter (mm)</b>	102
<b>Recess Depth (mm)</b>	110	<b>Cutout Diameter (mm)</b>	85
<b>Lamp Base</b>	GU10		

## SKU Table and Ordering

SKU Code
EN-DLM982X

### Compliance & Approvals:



### Accessories:

SKU Image	SKU Code	Description
	EN-BZ92	EFD™ PRO 102mm Adjustable Aluminium Downlight Bezel

### Warranty

This product has a warranty period of 5 Years. Warranties are valid from the date of purchase. The warranty is invalid in the case of improper use, installation, tampering, removal of the Q.C. date label or installation in an improper working environment or installation. Should this product fail during the warranty period it will be replaced free of charge, subject to the correct installation of the original product and subsequent return of the faulty unit. Aurora does not accept responsibility for any installation costs associated with the replacement of this product and Aurora reserves the right to alter specifications without prior notice.

**UK Enlite Sales & Distribution**  
Apex Park  
6 Little Burrow  
Welwyn Garden City AL7 4SW  
United Kingdom  
Tel : +44 (0) 1707 35 18 20