

Installation Instructions for 'Vela' Range Emergency Driver Kit

Model Number: LEDLEPN

SAFETY

Important: This product should be installed by a competent person and in accordance with the current IET Wiring Regulations.

If in doubt consult a qualified electrician.

WARNING

- Before installation, maintenance or lamp replacement, ensure that the mains supply to the luminaire is switched off and the circuit supply fuses are removed or the circuit breaker is turned off. Installation should comply with BS 5266 - Part 1

INSTALLATION

- Cut out two holes in the ceiling, the emergency bezel cut out is 18mm dia, please refer to your Vela downlight fitting instructions for the hole cut out for the downlight. (See Dia.1)
- Place the indicator light wire into the 18mm hole, feed the plug through to the downlight fitting hole. (See Dia.2)

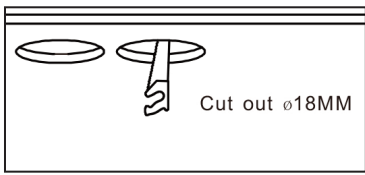

Dia:1

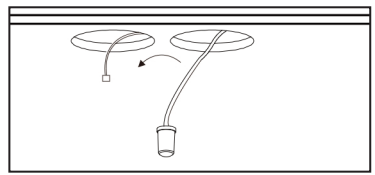

Dia:2

- Connect the downlight driver to the emergency driver via the plug, then connect mains wiring.
- Then connect the indicator light wire to the emergency driver. Place the drivers into the ceiling. (See Dia.3). Connect and install downlight.

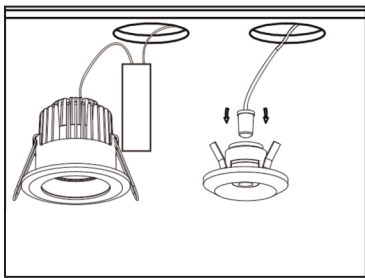

Dia:3

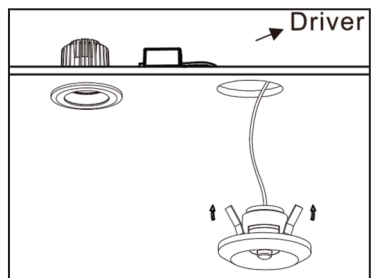

Dia:4

- Put the indicator light into the bezel (See Dia.3), then push the springs on the bezel into the vertical position push the bezel into the ceiling (See Dia.4).
- Once the clips have been released the Emergency bezel will lock into the ceiling. (See Dia.5)

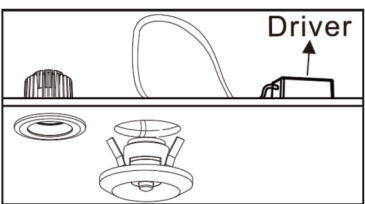

Dia:5

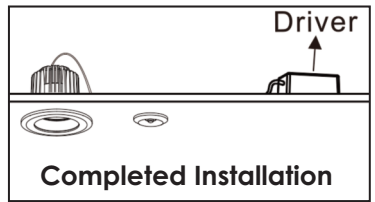

INSTALLATION DIAGRAM

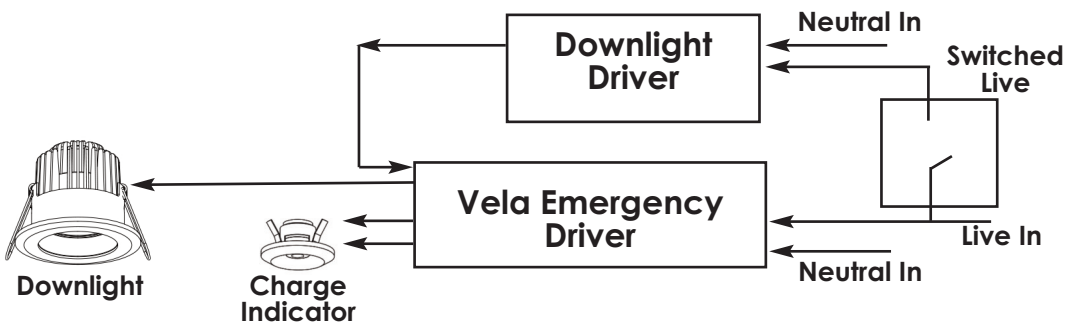

Routine Inspection & Test Procedure

All tests should be undertaken during daylight hours at times of minimum risk and be in accordance with the recommendations of BS 5266 Part 1.

DAILY - Check that the green LED battery charging indicator is illuminated.

MONTHLY - In addition to the daily check, a functional test through simulation of mains supply failure should be carried out to confirm lamps are illuminated from the battery cell pack supply. This test need only be approximately 30 seconds. It should not exceed one quarter of the rated luminaire duration.

SIX - MONTHLY - In addition to the monthly test, the lamps should be illuminated from the battery cell pack supply for a continuous period of at least one hour.

THREE - YEARS - In addition to the monthly tests the lamps should be illuminated from the battery cell pack supply for the full rated duration of the luminaire. (180 minutes).

ANNUALLY THEREAFTER - As above, i.e, Check that the luminaire operates for the full rated duration (180 minutes).

At the end of each test period the mains supply should be restored and a check made to ensure that the green LED battery charging indicator is illuminated.

EMERGENCY LUMINAIRE TEST RECORD SHEET

LUMINAIRE TYPE/REF: _____

DATE OF INSTALLATION: _____

LOCATION: _____

Month	Test	1st Year		2nd Year		3rd Year		4th Year		5th Year	
		Signed	Date	Signed	Date	Signed	Date	Signed	Date	Signed	Date
1	FUNCTIONAL										
2	FUNCTIONAL										
3	FUNCTIONAL										
4	FUNCTIONAL										
5	FUNCTIONAL										
6	FUNCTIONAL										
7	FUNCTIONAL										
8	FUNCTIONAL										
9	FUNCTIONAL										
10	FUNCTIONAL										
11	FUNCTIONAL										

TECHNICAL INFORMATION

Rated Voltage:	230V~50Hz
Emergency Output Power:	3W
Max Output Voltage:	36V
Max Output Current:	90mA
Battery Type:	3.6V 3,000Ah - Lithium Ion
Battery Life:	20,000Hrs
Emergency Operation:	3 Hours
Emergency Switch Time:	<1s
Working Environment:	-20°-50° / 65+20% RH
Charge Time:	>24hrs
Dimensions:	L150 x W45 x D34mm

GUARANTEE
 Your GreenBrook 'Vela' Emergency Kit
 LEDLEPN is guaranteed for 1 year from
 the date of purchase.
 This is in addition to your statutory rights.

Note: When disposing of this item and its packaging please follow local regulations and use an appropriate waste disposal centre. Please see the GreenBrook website for further details.

*Please keep these
instructions for future reference.*

INSTALLER - Please pass instruction manual onto the owner of the unit



**GREEN
BROOK**
ELECTRICAL
WEST ROAD . HARLOW
ESSEX . CM20 2BG . UK
info@greenbrook.co.uk
www.greenbrook.co.uk