

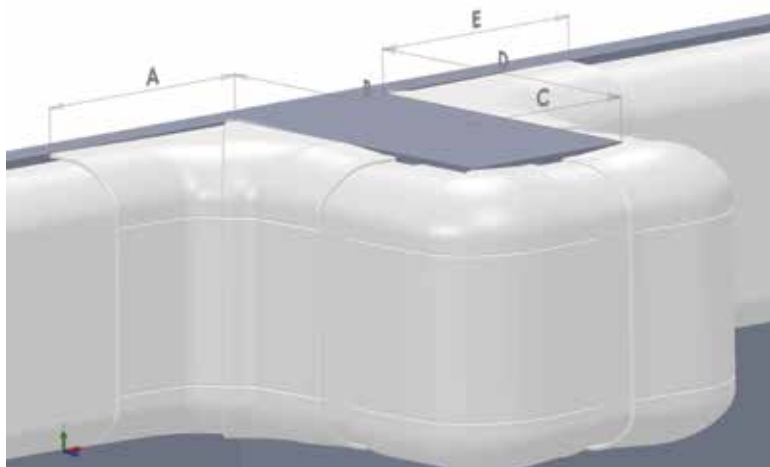

## elite compact trunking key features



- 145mm x 50mm profile
- Aesthetically pleasing curved design
- Manufactured from high impact resistant uPVC compound
- Suitable for Dado or Skirting mounting either vertically or horizontally
- Pre-punched base
- Large pre-punched knockouts located on both internal walls
- Full range of fittings and accessories
- Attractive two piece adjustable Internal and External covers to accommodate walls that do not have a true 90 degree
- Internal and External Angles maintain necessary bend radius to comply with British, European and International standards, including CAT5E, CAT6, Shielded, CAT7 and the new CAT6A 10 gig solution
- Moulded Flat Tee and Flat Angle with data guide to maintain necessary bend radius and cable segregation
- Moulded Flat Tee and Flat Angle overlap Trunking to prevent need of additional Joint Covers
- Screw fit fittings available (optional)
- 1 and 2 Gang open sided frames
- Pre-punched Steel Screen Divider (BSEN50174-2)
- DDA Compliancy obtainable
- ROHS Compliant
- ELITE Compact Hygieia Range available – antimicrobial protection
- Available as pre-assembled units

# elite compact trunking technical information



## dimensions and cable capacities

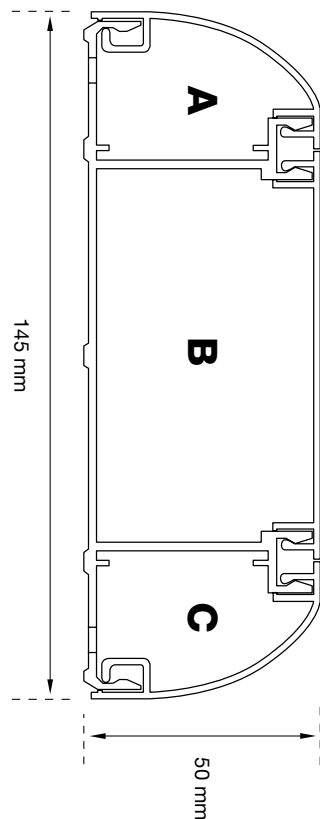

DATA CABLE DIAMETER (mm)	NOMINAL CSA (mm <sup>2</sup> )	COMPARTMENT A 1040mm <sup>2</sup>	COMPARTMENT B			COMPARTMENT C 1040mm <sup>2</sup>
			3590mm <sup>2</sup>	3590mm <sup>2</sup> and 25mm BOX	3590mm <sup>2</sup> and 35mm BOX	
		45% Fill (468mm <sup>2</sup> )	45% Fill (1615mm <sup>2</sup> )	45% Fill (813mm <sup>2</sup> )	45% Fill (488mm <sup>2</sup> )	45% Fill (468mm <sup>2</sup> )
5	19.6	24	82	41	24	24
5.5	23.8	20	67	34	20	20
6	28.3	17	57	28	17	17
6.5	33.2	14	48	24	14	14
7	38.5	12	41	21	12	12
8	50.3	9	32	16	9	9
9	63.6	7	25	12	7	7
10	78.5	6	20	10	6	6

POWER CABLE CONDUCTOR CSA (mm <sup>2</sup> )	CABLE FACTOR	COMPARTMENT A 1040mm <sup>2</sup>	COMPARTMENT B			COMPARTMENT C 1040mm <sup>2</sup>
			3590mm <sup>2</sup>	3590mm <sup>2</sup> and 25mm BOX	3590mm <sup>2</sup> and 35mm BOX	
		45% Fill (468mm <sup>2</sup> )	45% Fill (1615mm <sup>2</sup> )	45% Fill (813mm <sup>2</sup> )	45% Fill (488mm <sup>2</sup> )	45% Fill (468mm <sup>2</sup> )
1.5	8.6	53	187	98	61	53
2.5	12.6	36	126	67	41	36
4	16.6	27	97	51	31	27
6	21.2	21	76	40	25	21

Typical cable loading information in line with wiring regulation BS 7671 (45% CSA Fill)

**STANDARDS** - ELITE Compact Trunking system meets and exceeds the requirements for:  
BS6701, ISO/IEC11801(ED2.0 Amd 2) and Cenelec (BSEN50173 Part 1/2, BSEN50174-2) BS4678 Pt 4, BS7671 (IEE regs)



# elite compact trunking accessories



**MEC3**



**MEC3F**



**MEC3T**



**MEC3I**



**MEC3E**



**MEC3C**



**MEC3J**



**MEC3SD**



**MEC3SDE**



**MTDDA1 (BL-CH-LG)**



**MTDDA2 (BL-CH-LG)**



**MTLS**

# elite compact trunking accessories



**MEC3TOA**



**MEC3RCDH**



**MTSB1, MTSB1-4,  
MTSB1-25, MTSB1-25-4**

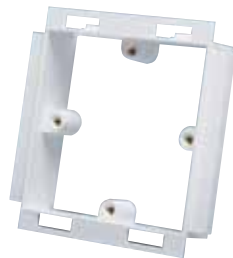

**MTSB1-F**



**MTSB2**

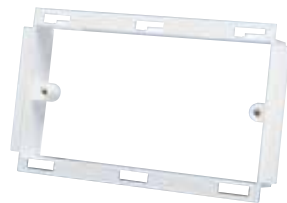

**MTSB2-F**



**SECURITY FITTINGS**

CODE	DESCRIPTION	PACK SIZE
<b>MEC3</b>	Marco ELITE compact Trunking 145 x 50mm	2 x 3m
<b>MEC3F</b>	Flat angle	1
<b>MEC3T</b>	Flat tee	1
<b>MEC3I</b>	Internal adjustable angle	1
<b>MEC3E</b>	External adjustable angle	1
<b>MEC3C</b>	End cap	2
<b>MEC3J</b>	Joint cover	5
<b>MEC3SD</b>	Steel screen divider	4 x 1.5m
<b>MEC3SDE</b>	ELITE compact external angle screening divider	1
<b>MTDDA1 (BL-CH-LG)</b>	Coloured back plate 1-gang	10
<b>MTDDA2 (BL-CH-LG)</b>	Coloured back plate 2-gang	10
<b>MTLS</b>	Accessory spacer	10
<b>MEC3TOA</b>	Take off adaptor	1
<b>MEC3RCDH</b>	RCD/MCB DIN rail housing (includes: hinged cover, mounting frame, mounting bracket, Marco locking mechanism available)	1
<b>MTSB1</b>	Socket mounting box 35mm 1-gang	10
<b>MTSB1-4</b>	Socket mounting box 35mm 1-gang 4 pillar	10
<b>MTSB1-25</b>	Socket mounting box 25mm 1-gang	10
<b>MTSB1-25-4</b>	Socket mounting box 25mm 1-gang 4 pillar	10
<b>MTSB1-F</b>	1-gang socket mounting frame	10
<b>MTSB2</b>	Socket mounting box 35mm 2-gang	10
<b>MTSB2-25</b>	Socket mounting box 25mm 2-gang	10
<b>MTSB2-F</b>	2-gang socket mounting frame	10
<b>SECURITY FITTINGS</b>	Please add suffix - SF to the standard catalogue number	