

Hamilton® Sheer CFX®

Concealed Fixing Accessories on Stylish Flat Plates

Sheer CFX® are simple and elegant, flat-plate switches and sockets. The range features Hamilton's patented CFX® 4 point face plate clipping system allowing concealed fixing for a clean and contemporary finish that looks stylish in any environment. Sheer CFX® also benefits from an integral gasket that forms part of the mounting frame, this is ideal for use on walls that are not perfectly flat.

- Minimalist, modern flat plate
- Six finishes
- Concealed fixing
- Integral gasket – ideal for imperfectly flat walls
- Grid Fix and Eurofix options also available (see separate GRID-IT and EuroFix sections)



87C 2X40



84C DTRID W



81C T22



89C SPN AB-B



84C 1X40



88C R22 BK-B

Hamilton Sheer CFX® Concealed Fixing

← Plate Depth 4.5 mm including gasket

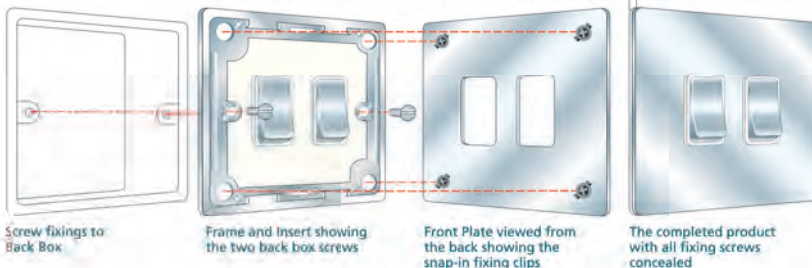

Hamilton® *fashion, finish, function and flexibility*

Concealed Fixing GRID-IT Grid Fix Plates complete with Fixing Grid

Minimum Wall Box Depth dependant on GRID-IT insert fitted - please see the GRID-IT section for our complete range of inserts.



1 gang Aperture Grid Fix Plate

Nominal Plate Size:
86 x 86 mm

Technical Insert
Reference: **1GP**

Product Code



2 gang Aperture Grid Fix Plate

Nominal Plate Size:
86 x 86 mm

Technical Insert
Reference: **2GP**

Product Code



3 gang Aperture Grid Fix Plate

Nominal Plate Size:
145 x 86 mm

Technical Insert
Reference: **3GP**

Product Code



4 gang Aperture Grid Fix Plate

Nominal Plate Size:
145 x 86 mm

Technical Insert
Reference: **4GP**

Product Code

Plate Finish

Bright Chrome



87C 1GP

87C 2GP

87C 3GP

87C 4GP

Polished Brass



81C 1GP

81C 2GP

81C 3GP

81C 4GP

Satin Brass



82C 1GP

82C 2GP

82C 3GP

82C 4GP

Antique Brass



89C 1GP

89C 2GP

89C 3GP

89C 4GP

Satin Stainless



84C 1GP

84C 2GP

84C 3GP

84C 4GP

Black Nickel



88C 1GP

88C 2GP

88C 3GP

88C 4GP

Spare Grids complete with Gasket



1 gang Grid with Gasket

Nominal Grid Size:
86 x 86 mm

Technical Insert
Reference: **8C1G**

Product Code

8C 1G



2 gang Grid with Gasket

Nominal Grid Size:
86 x 86 mm

Technical Insert
Reference: **8C2G**

Product Code

8C 2G



3 gang Grid with Gasket

Nominal Grid Size:
145 x 86 mm

Technical Insert
Reference: **8C3G**

Product Code

8C 3G



4 gang Grid with Gasket

Nominal Grid Size:
145 x 86 mm

Technical Insert
Reference: **8C4G**

Product Code

8C 4G