



VMHBL

Temporary locking facility (For use with Design 30 Consumer Units)
Instructions/Data Sheet

This device allows the board to be isolated for the safety of tradespersons during construction of a building. The lock surround forms no part of the non-combustable enclosure. With the lock surround removed, the rating of IP2XC is maintained.

Padlock shown is available: ref. JK25A

ZD0822

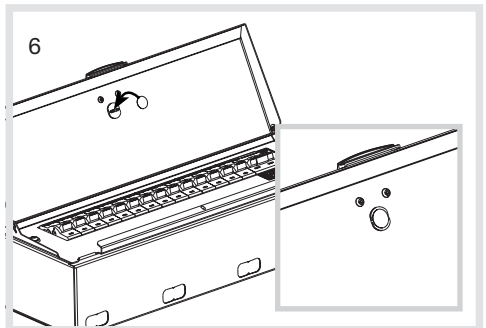
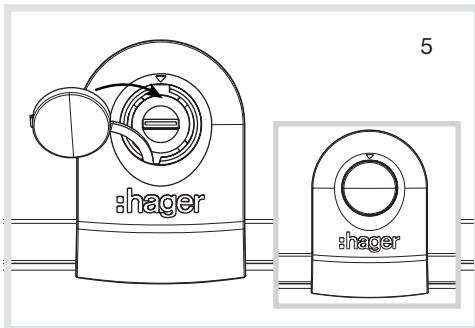
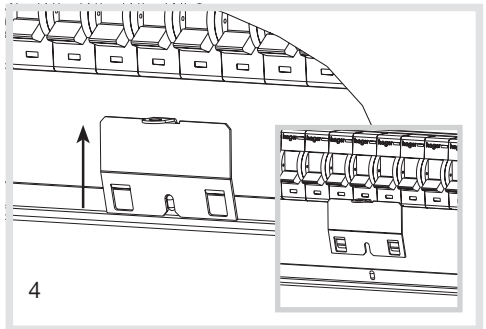
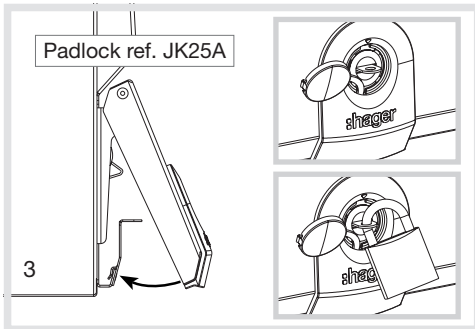
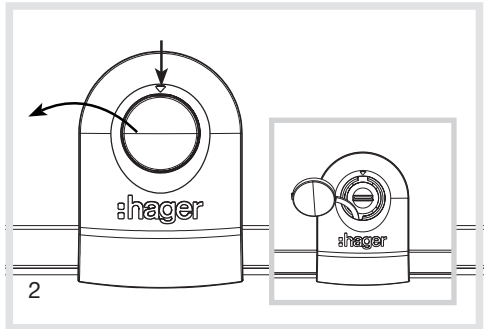
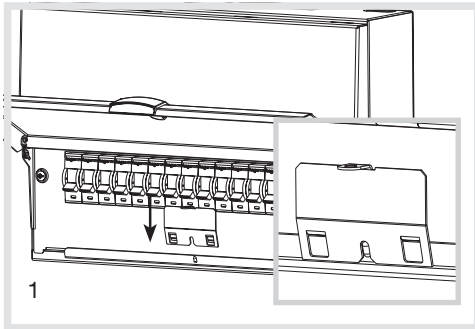
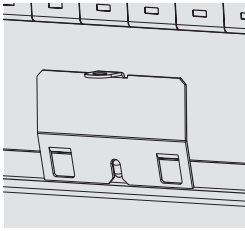

ZD0822