

Read these instructions before installation and retain for future reference. This equipment should be installed by a competent electrician

Important Information

We recommend that luminaires are installed by a qualified electrician ensuring the installation complies with current IEE wiring regulations BS7671:2018 & local building control.

- All tests should be carried out in accordance to EN 50172:2004.
- BELL will not accept responsibility for any claims arising from a poor installation.
- The light source of this luminaire is not replaceable: when the light source reaches end of life, the whole luminaire must be replaced.
- Isolate mains before installation.
- Note the IP (Ingress Protection) rating for this luminaire when deciding on the installation location.
- This product is Class II double insulated
- This product is IP65 rated.
- This product is non dimmable.
- You are advised to test 5 samples before mass application of sensor in a new lighting project. The distance between any inductive sensors should be greater than 3m.
- Microwave maximum operating height 3.2m
- Operating Temperature -30°C to +35°C, emergency versions 0°C to +35°C

Warning Before installation ensure power is disconnected.

This product may contain substances that can be hazardous to the environment if not disposed of properly. Electrical and electronic equipment should never be disposed of with general household waste but must be separated for its correct treatment and recovery.

Where possible recycle your packaging.

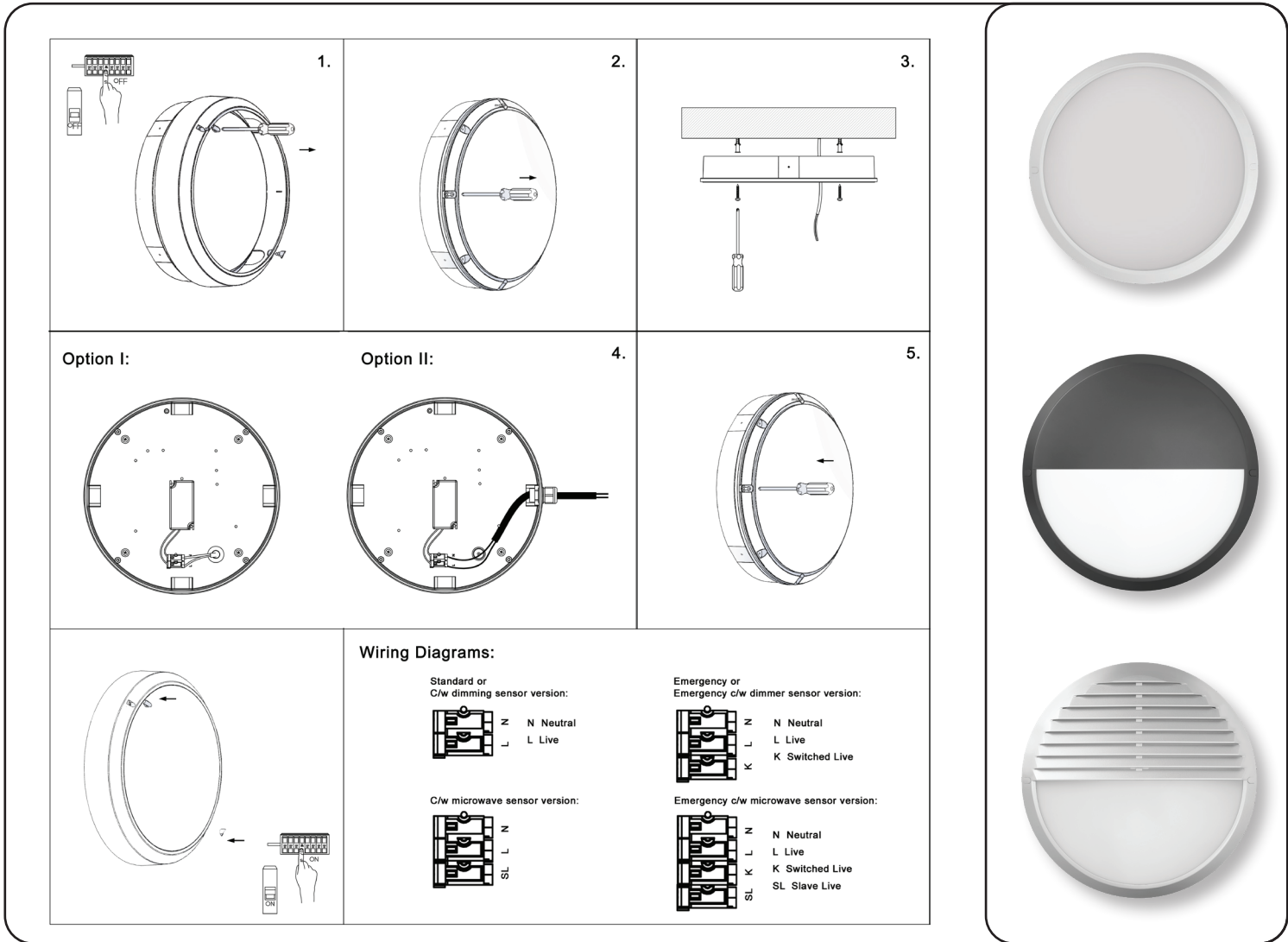

Testing & Commissioning for Emergency Luminaire

- Ensure the Load is connected.
- Connect the battery.
- Switch on the Unswitched Supply
- Check the Charge LED illuminates.
- Switch on the Maintained Supply
- Check the LED illuminates as normal.
- Switch off the Maintained Supply.
- Switch off the Unswitched Supply
- Check the Charge LED extinguishes and the load LED illuminates at a reduced output.
- Enter the commissioning date on the Battery Pack.
Switch on the Unswitched Supply

Luminaire Ref/Location	In Case of difficulty, contact the Installation Engineers:- Tel: _____									
Full Recharge Time 24 Hours	Duration 3 Hours					Lamp Type - LED				
ROUTINE TEST RECORD										
	Year 1		Year 2		Year 3		Year 4		Year 5	
Monthly Test	Signed	Date	Signed	Date	Signed	Date	Signed	Date	Signed	Date
Functional										
Functional										
Functional										
Functional										
Functional										
Functional										
Functional										
Functional										
Functional										
Functional										
Functional										
Functional										
Three Hour										

Read these instructions before installation and retain for future reference. This equipment should be installed by a competent electrician



SETTINGS:

Detection area: hold time and daylight sensor can be set using DIP switches on the sensor. Note that reducing the detection area will also reduce the sensitivity

1. Detection area

- I: up to 8m
- II: up to 6m
- III: up to 4m
- IV: up to 3m
- V: up to 2m

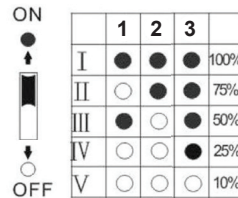

2. Hold time

Refers to the time period the lamp remains at 100% illumination after no motion detected

- I: 5s
- II: 30s
- III: 90s
- IV: 3min
- V: 20min
- VI: 30min

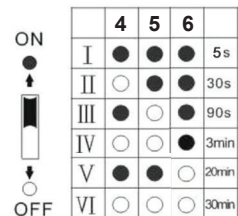

3. Daylight sensor

The sensor can be set to only allow the lamp to illuminate below a defined ambient brightness threshold. The settings are as follows:

- I: 2lux, darkness operation only
- II: 10lux, darkness operation only
- III: 25lux, twilight operation
- IV: 50lux, twilight operation
- V: Disable*

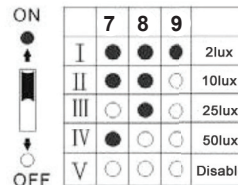

*When set to Disable mode, the daylight sensor will switch on the lamp when motion is detected regardless of ambient light level