

Plastic Emergency Stop Station



- RCAS-ESB141NC - Key Release + 1N/C
- RCAS-ESB541NC - Twist Release + 1N/C
- RCAS-ESBC41NC - Spring Release + 1N/C
- RCAS-ESBT41NC - Pull Release + 1N/C

Metal Emergency Stop Station



- RM1BS142 - Twist Release + 1N/C
- RM1BS542 - Spring Release + 1N/C

Technical Data

- EN 60947 Compliant
- Operating Temperature -25°C to +70°C
- IP65 rated enclosure
- Base mounted contact block for easy wiring
- Proven Design
- 1 N/C Contact rated 10A at 240V
- Provision for additional contact element
- Knock-outs 1 x top & bottom

Dimensions

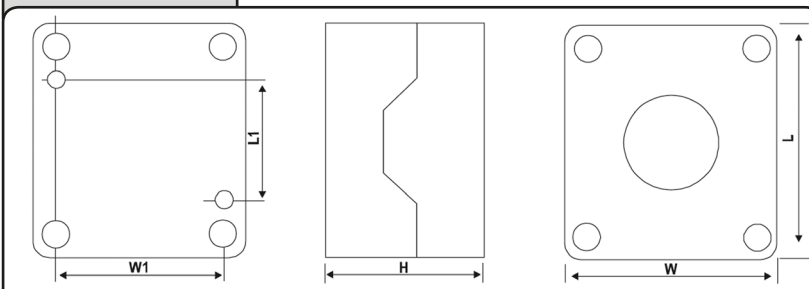

Plastic

Measurement	1 Hole
H	51mm
W	68mm
L	74mm
W1	54mm
L1	38mm

Legend Plate Stickers

Included with each control station

