

#### ⚠ Important Safety Notice

It is the responsibility of the person installing the electrical equipment to ensure that the installation meets the requirements of the IET wiring regulations and is therefore 'fit for purpose'. Factors such as correct selection of components, cable sizing, protective devices and Earth bonding are all critical and should be checked prior to full testing and power-up. Any other regulations applicable to the equipment being installed such as the Machinery Directive and current health and safety legislation must also be adhered to. All connections (including factory made) must be checked for the correct tightness prior to commissioning of the electrical installation. All connections should be checked periodically to ensure correct tightness.

**DO NOT USE POWER TOOLS ON THESE PRODUCTS**



## IP67 16A | 32A Two Way Splitters

### Dimensions

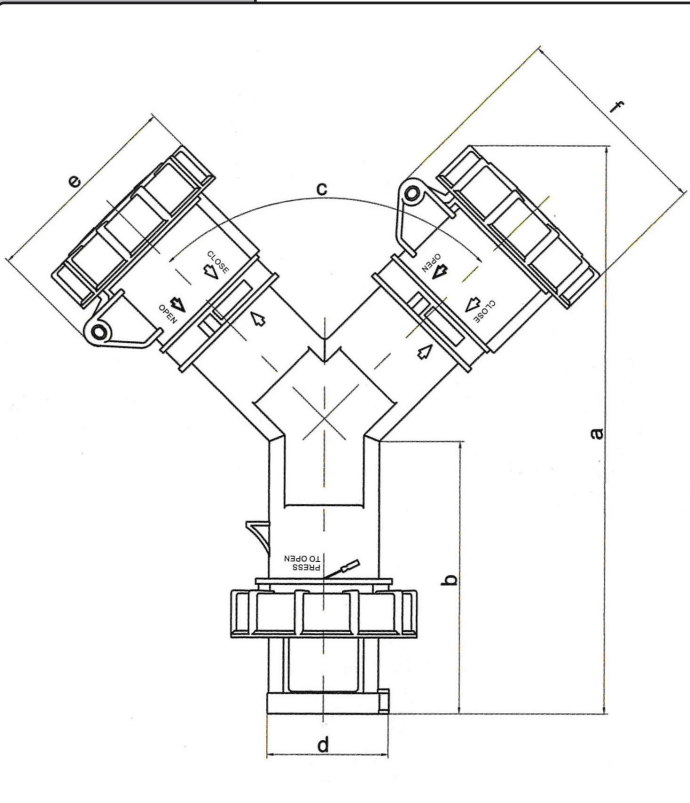

### Images

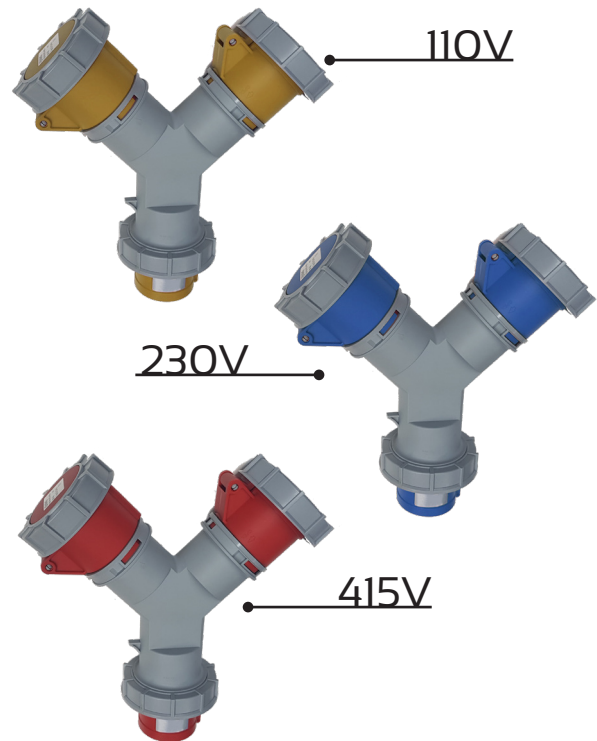

Part Number	Amps (A)	Description	Earth Contact Position	Voltage	A	B	C	D	E	F
ISPW2163F	16	2P + E	4h	110V	219.7	105.4	90	46.8	79.2	85
ISPW2163P				230V	227.3	103.4		53.4		
ISPW2164N		3P + E	6h	415V	233.3	102.2		60.5	90.3	
ISPW2165N		3P + N + E								
ISPW2323F	32	2P + E	4h	110V	249.8	124.3	90	63	96.5	108.5
ISPW2323P				230V						
ISPW2324N		3P + E	6h	415V	301.9	141		69.5	108.5	
ISPW2325N		3P + N + E								

## IP67 16A | 32A Three Way Splitters

### Dimensions

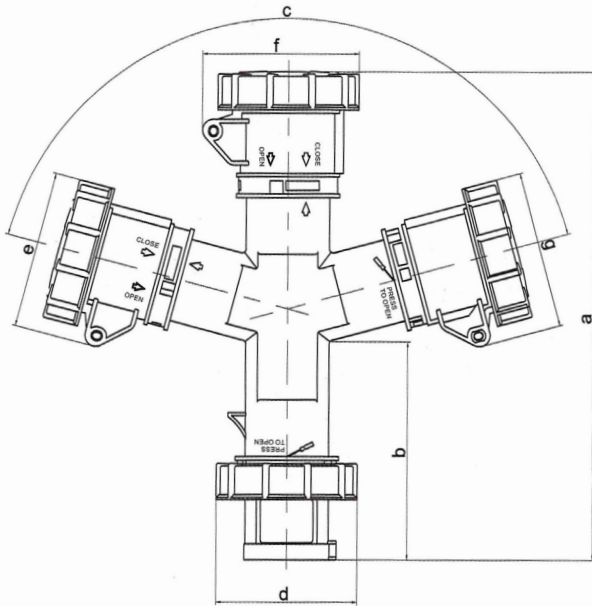

### Images

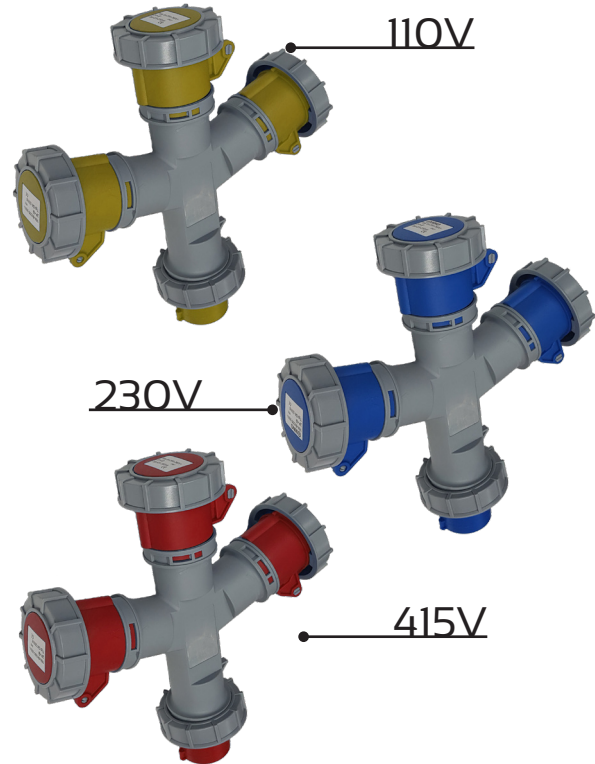

Part Number	Amps (A)	Description	Earth Contact Position	Voltage	A	B	C	D	E	F	G					
ISPW3163F	16	2P + E	4h	110V	246.2	110	150	71.5		79.2						
ISPW3163P				230V	255.2	107		79.5		85						
ISPW3164N		3P + E	6h	415V	257.7	106.3		87.5	90.3							
ISPW3165N		3P + N + E														
ISPW3323F	32	2P + E	4h	110V	323.1	144.4	150	93.5		96.5						
ISPW3323P				230V												
ISPW3324N		3P + E	6h	415V								329	142.1	101	108.5	
ISPW3325N		3P + N + E														